

Demolition Tools



**THOMAS
TURTON**





Demolition Tools

Introduction

Our manufacturing experience on Demolition Tools covers a period of over thirty years, throughout which we have continued to develop high quality tools for an ever-demanding marketplace.

Thomas Turton has one quality - the best. All tools are totally manufactured and processed within our modern factory, utilising the very latest machinery and technology, which ensures that our finished products comply with the high standards of quality expected by our customers worldwide. We operate a Quality Management System which is certified to BS EN ISO9001:2008 standard.

Our Demolition Tools are manufactured from specially selected steel specifications which have been evolved from a rigorous research and development programme. We continually investigate refinements to specifications and processes, to ensure that our quality leads the market.

Our in-house Heat Treatment Plant is one of the largest of its kind in Europe and enables us to closely control and monitor all aspects of the unique processes we have developed.

The result is a range of quality Demolition Tools that have the hardness, impact strength and durability required to combat the most arduous conditions experienced in demolition, trenching, road construction, quarrying and mining applications.

Our Demolition Tools are acknowledged by many major OEMs as the best independently produced tools available worldwide. One quality - the best.

Contents

	Page		Page
Introduction	1	Krupp	31-34
Warranty	2	Montabert	35-39
Tools Selection	2	MSB	40-42
Care and Use	3	NPK	43-47
Catalogue Numbering System	4	Rammer	48-52
Chisel Orientation	4	Rotair	53
Machine Index	5	Socomec	54-55
Hammer Type & Tool Reference Index	6-12	Soosan	56-58
Atlas Copco	13-17	Toku	59-61
Furukawa	18-21	Toyo	62-64
Hanwoo	22-23	Other Manufacturers Reference Index	65-66
Indeco	24-27	Warranty Guide	67-68
Italdem	28-30		



Warranty

Thomas Turton's tools are guaranteed against defects in raw material and manufacture. No other warranty is implied or expressed. The company's liability in respect of any warranty claims is limited to replacement and does not extend to any other expenditure incurred or to any consequential damage. Warranty claims are subject to immediate notification of any problems and return of the goods to us under our returned goods system. See pages 67 & 68 for our full warranty details.

Tools Selection

Correct selection of tools is the first step in obtaining maximum life from the product.



Conical Point - for general demolition work where penetrative breaking is required.



Pyramid Points - for use where increased breakout forces are required



X Type Point - for use in soft or high dust operations.



Power Point - tool with hard core for use in very hard and abrasive conditions.



Chisels - as for Points but also where a cutting action is required, eg. trenching and benching
Note: Chisels give higher wear rates and stress levels in the retainer flat areas of the tool.



Grooved Chisel - for use in soft or high dust operations.



Wide Chisels - for increased productivity in softer materials.
Tarmac Cutters - as Wide Chisels but with 90 degree orientation for cutting/trenching.



Rail Guard - for driving in rail guards.



Blunts - for impact breaking, eg. secondary breaking and also scaling in mines and tunnels, etc.



Upset Blunt - Blunt with increased diameter at working end to give increased life and wear resistance.



Rammer Stems & Pads - for compacting loose ground.



Driving Tool - for driving in posts, pipes etc.

Care and Use

Working Angle

Critical to tool life is using the tool at the correct working angle of 90° to the working surface. Failure to do this will result in high contact pressure between the tool and the bushings and the likelihood of galling between the surfaces. In turn this can lead to premature failure of the tool plus damage and rapid wear to the bushings. Worn bushings can allow the tool to be angled over to a position where the striking face is hit at an angle by the piston.

Lubrication

Lubrication of the tool/bushing with the correct quality high temperature/high pressure grease at regular intervals is essential. Such greases are best able to cope with the extreme contact pressures generated by an incorrect working angle, leverage and excessive bending etc.

USE OF CHEAP SUBSTITUTES (OR NO GREASE AT ALL) IS FALSE ECONOMY AND WILL RESULT IN PREMATURE TOOL FAILURE.

Blank Firing

Continuing to use the hammer when the tool is not or only partially in contact with the work surface will result in the tool being fired down on to the retainer pin. This will cause heavy wear and damage to the upper retainer flat radius area and the retaining pin itself.

Tools should be examined regularly, eg. every 40 hours for damage in this area which should then be ground out.

At the same time as the tool is examined the opportunity should be taken to check the tool bushings for wear and damage with a view to replacement or reconditioning as necessary.

Overheating

Avoid continuous working in one position. Do not strike in one spot for more than 10 - 15 seconds before changing the tool to another position. Failure to do this can lead to excessive heat build-up at the working end with 'mushrooming' as a consequence.

Leverage/Bending

Using the tool as a lever to help break the ground is a common tool breaker. Avoid leverage and excessive bending at all times.

Loose running

Keep the boom and hammer feed sufficient to ensure that the tool is held against the hammer shoulder stop, at all times when working.

Tool Reconditioning

Under most normal conditions the tool will not need reconditioning. However, tools that have lost their shape on the working end can cause high stresses throughout the tool and hammer. Reconditioning by milling or turning is recommended. Welding or flame cutting is not recommended as the heat generated could cause structural changes within the material which in turn can lead to premature failure or rapid wear.

Catalogue Numbering System

All catalogue numbers start with **2 letters**, followed by a **2 digit number**, which is our designation for the hammer type, eg. **MB35P0410**.

The second section defines the tool length and type, eg. MB35**P0410**. The last **4 digits** eg. **0410** represent the tool length in millimetres, whilst the working end configuration is defined by a letter:

'P' = Point (Conical)

'C' = Chisel

'B' = Blunt

'PP' = Pyramid Point

'XP' = 'X' point

'GC' = grooved chisel

'BU' = blunt upset

'CT' = Power Point

'WC' = Wide Chisel, followed by blade width, eg. MB35**WC041R120**

'TC' = Tarmac Cutter (in-line wide chisel) eg. MB35**TC041R120**

For correct selection of tool types see page 2

Note: For special tools such as Railguards, Rammer Stem & Pads and Driving Tools, please contact our sales office.

Chisel Orientation

Transverse (East/West) have the blade of the tool transverse to the axis of the carrier boom when mounted.

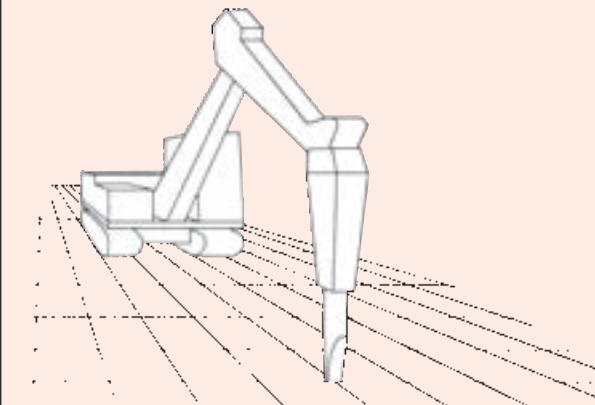

All standard chisels and wide chisels have the blade in the transverse mode.

In-Line (North/South) have the chisel tool blade "In-Line" (parallel) to the axis of the carrier boom.

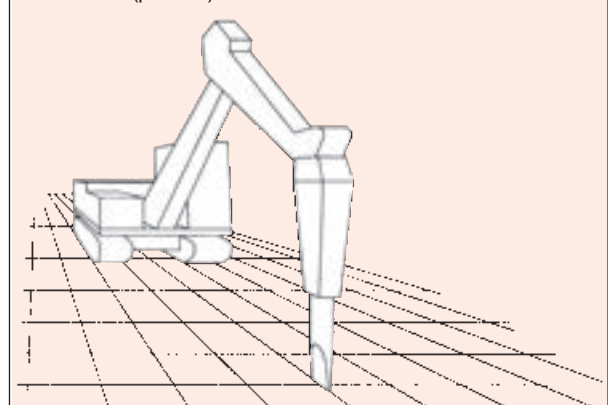

All in-line chisels and tarmac cutters have the blade in the "in-line" mode.

Machine Index

Machine	Fig. No.	Page	Machine	Fig. No.	Page
ARDEN		65	MONTABERT		35-39
ARROWHEAD		46, 65	MSB		40-42
ATLAS COPCO		13-17	NPK		43-47
BERCO		13	OCM		35-36
BOBCAT		65	O&K		48-52
CASE		48-51	OKADA		66
CATERPILLAR		48-52	OMAL		35, 53
CHICAGO PNEUMATIC	13, 16-17, 33-34		OMD		35
DAEMO		65	PEL-JOB		53
D&A		65	PROMOVE		35-36
DEHACO		62-64	RAMMER		48-52
DRAGO		59-60	ROTAIR		53
EURORAM		24-27	SOCOMECH		54-55
FURUKAWA		18-21	SOOSAN		56-58
GEHL		53	STANLEY		56-58, 66
HANWOO		22-23	STAR	28-29, 35-36	
HUSKIE/IZUMI		65	TABE		66
IDROMECCANICA		35	TAKEUCHI		62-64
INDECO		24-27	TELEDYNE		59-61
ITALDEM		28-30	TOKU		59-61
JCB		48-52	TOPA		66
JKHB		62-64	TOYO		62-64
KRUPP		31-34	VIBRAM		66
KUBOTA		48	VOLVO		48-52
LIFTON		65	WIMMER		40-41

Hammer Type & Tool Reference Index

Machine	Fig. No.	Page	Machine	Fig. No.	Page
ARDEN			ATLAS COPCO - cont.		
AB100	275	65	TEX 1400H	16	15
AB150/210	276	65	TEX 1800H/2000H	17	15
AB280/350	277	65			
AB450	279	65	BERCO		
AB1050	280	65	BB42	1	13
ARROWHEAD			BB52	2	13
S20	281	65	BB62	3	13
S30	282	65	BB70	4	13
S40	283	65	BB80	5	13
S60	284	65			
2T	176	46	BOBCAT		
4T	178	46	B300	126	36
6T	179	46	B500	127	36
10T	285	65	580	137	38
22T	286	65	680	138	38
			B700	128	37
ATLAS COPCO			B850/B950	129	37
PB110	1	13	880	139	38
PB160	2	13	980	140	39
PB210	3	13	1250	329	65
PB310	4	13	1560	330	65
PB420	5	13	1750	187	48
SB50,SBC 60	6	13	2500/2570/3560	331	65
SB100,SBC 115	7	14	5500	332	65
SB150,SBC 255	8	14	6560	333	65
SB200,SBC 410	9	14			
SB300,SBC 610,SBC650	10	14	CASE		
SB300 SCALER	11	14	CB140	187	48
SB450,SBC 800/850	14	15	CB200	188	48
MB500	19	16	CB370	189	48
MB700, MB800	20	16	CB620	190	48
MB1000	21	16	CB735	192	49
MB1200	22	16	CB1150	193	49
MB1700	23	16	CB1450	203	50
HB2200	24	16	CB2850	205	51
HB3000	25	17	CB3750	206	51
HB4200	26	17	CB4000	207	51
HB5800	27	17	CB5200	208	51
HB7000	28	17			
HBC 1100/1700	15	15	CATERPILLAR		
HBC 2500	16	15	CAT H45FT	187	48
HBC 4000	17	15	CAT H50FT	188	48
HBC 6000	18	15	CAT H63/H63FT	189	48
TEX 30H	6	13	CAT H70/H70FT	190	48
TEX 75H/100H	7	14	CAT H90/H90FT	192	49
TEX 110H	8	14	CAT H100/H100FT	193	49
TEX 180H	9	14	CAT H115s	203	50
TEX 250H	12	14	CAT H120s	205	51
TEX 250H SCALER	13	15	CAT H130s	206	51
TEX 400H	14	15	CAT H140As	199	50
TEX 600H/700H/900H	15	15	CAT H140Cs/H140Ds	207	51
			CAT H160As	200	50
			CAT H160Cs/H160Ds	208	51
			CAT H180s	209	51
			CAT H180Ds	210	52
			CAT H195	211	52

Hammer Type & Tool Reference Index

Machine	Fig. No.	Page	Machine	Fig. No.	Page
CHICAGO PNEUMATIC (CP)			EURORAM - contd.		
CP100	1	13	RM80	67	24
CP150	2	13	RM85/90	70	25
CP200	3	13	RM110	71	25
CP300	4	13	RM115	72	25
CP400	5	13	RM120	73	25
CP550	5	13	RM130	74	26
CP750	105	32	RM140	75	26
CP1150	108	33	RM145	76	26
CP1550	110	33	RM150	77	26
CP2250	112	34	RM160	78	27
CP3050	114	34	RM180	79	27
CP4250	115	34	RM195	80	27
DAEMO			FURUKAWA		
DMB S500	287	65	F1	29	18
DMB S1300	288	65	F2	30	18
DMB S1800	289	65	F3	31	18
DMB S2200	290	65	F4	32	18
DMB S3000	291	65	F5	33	18
DMB S3600	292	65	F6	34	18
D&A			F9	35	19
8V	275	65	F12	36	19
15V/20V	276	65	F19	37	19
30V/50V	277	65	F22	38	19
70V	278	65	F27	39	19
130V	280	65	F35	40	19
180V	293	65	F45	41	20
DEHACO			F70	42	20
DHB 35	261	62	HB1G	43	20
DHB 55	262	62	HB2G	44	20
DHB 75	263	62	HB3G	45	20
DHB165	264	62	HB5G	46	20
DHB 305	266	63	HB8G	47	21
DHB 405	267	63	HB10G	48	21
DHB 805	268	63	HB15G	49	21
DHB 1250	269	63	HB20G	50	21
DHB 1305	270	63	HB30G	51	21
DHB 1605 (1405)	271	64	HB40G	52	21
DHB 2305	272	64	HANWOO		
DHB 3205 (4105)	273	64	RHB 301-V	53	22
DRAGO			RHB 302/303-V	54	22
DRH 80	246	59	RHB 303	55	22
DRH120	247	59	RHB 305-V	56	22
DRH150	248	59	RHB 308-2/309	57	22
DRH180	249	59	RHB 313-V	58	22
DRH280	250	59	RHB 322-2/325	59	23
DRH650S/900	251	60	RHB 328-2/330	60	23
DRH1150S/1600S	252	60	RHB 340	61	23
DRH1900	253	60	HUSKIE/IZUMI		
EURORAM			HH100	294	65
RM45	62	24	HH150	295	65
RM48	63	24	HH300	296	65
RM56	64	24	HH500	297	65
RM65	65	24	HH750	298	65
RM75	66	24	HH1000	299	65
			HH2000	300	65

Hammer Type & Tool Reference Index

Machine	Fig. No.	Page	Machine	Fig. No.	Page
HUSKIE/IZUMI - contd.			INDECO - contd.		
HH3600	301	65	UP900	69	25
HH4500	302	65	UP1200	70	25
IDROMECCANICA			UP1500	71	25
IMI 85	118	35	UP1750	72	25
IMI 260	120	35	UP2000	73	25
IMI 600	121	35	UP2500	74	26
IMI 1000	122	35	UP3000	75	26
INDECO			UP3500	76	26
HB5	65	24	UP4000	77	26
HB8	67	24	UP5000	78	27
HB12	70	25	UP7000	79	27
HB19	71	25	UP8500	80	27
HB27	73	25	ITALDEM		
HP150	62	24	GK 85/86	81	28
HP200	63	24	GK 160/161	82	28
HP350	64	24	GK211	83	28
HP500	65	24	GK 290/291	84	28
HP600	66	24	GK 360/361	85	28
HP700	68	25	GK 600/610	86	29
HP900	69	25	GK 950/960	87	29
HP1200	70	25	GK 1350	88	29
HP1500	71	25	GK1351S	89	29
HP1800	72	25	GK 1600	90	29
HP2000	73	25	GK 2400	91	30
HP2500	74	26	GK 3400/3500	92	30
HP3000	75	26	GK3800	93	30
HP3500	76	26	K 80	118	35
HP4000	77	26	K 270	120	35
HP5000	78	27	K 550	121	35
HP7000	79	27	K 1000	122	35
HP9000	80	27	K 1030	124	36
MES 121/150	62	24	K 1300	125	36
MES 180/181/200	63	24	JCB		
MES 300/301/350/351	64	24	JCB HM160	187	48
MES 451/452/462/521/550	65	24	JCB HM260	189	48
MES 553	66	24	JCB HM360	190	48
MES 601/621/650	68	24	JCB HM550	192	49
MES 1200	70	25	JCB HM850	193	49
MES 1500	71	25	JCB HM1050	203	50
MES 1750/1800	72	25	JCB HM1150	202	50
MES 2000	73	25	JCB HM1350	205	51
MES 2500	74	26	JCB HM1450	204	51
MES 3000	75	26	JCB HM1750	206	51
MES 3500	76	26	JCB HM2350	207	51
MES 4000	77	26	JCB HM2950	208	51
MES 5000	78	27	JCB HM3850	209	51
MES 7000	79	27	JCB HM3950	210	52
MES 8500	80	27	JKHB		
UP121/150P	62	24	JKHB 31	261	62
UP181/200P	63	24	JKHB 51	262	62
UP301/350P/351P	64	24	JKHB 71	263	62
UP462/521/550P	65	24	JKHB 101	264	62
UP553	66	24	JKHB 301	266	63
UP621/650P	68	25	JKHB 401	267	63
			JKHB 801	268	63

Hammer Type & Tool Reference Index

Machine	Fig. No.	Page	Machine	Fig. No.	Page
JKHB - contd.			MONTABERT - contd.		
JKHB 1101	269	63	BRH501/570	122	35
JKHB 1401	270	63	BRH620	123	36
JKHB 1600	271	64	BRH625	124	36
JKHB 2000	272	64	BRH750	125	36
JKHB 3000	273	64	30	126	36
KRUPP			50/50SMS	127	36
AT20	1	13	70/70SMS	128	37
AT70	2	13	85/85SMS/90/90SMS	129	37
AT120	3	13	125SX	130	37
AT170	4	13	140/140SMS/150/150SMS	131	37
AT220	5	13	300/300MS	132	37
HM50/55	94	31	700/700SMS	133	37
HM60V	95	31	900/900MS	134	38
HM60/75	96	31	1200/1200SMS	135	38
HM85/90/90V	97	31	SILVER CLIP 08 (SC08)	136	38
HM130/140V	98	31	SILVER CLIP 12 (SC12)	137	38
HM185/190V	99	31	SILVER CLIP 16 (SC16)	138	38
HM200	100	32	SILVER CLIP 22 (SC22)	139	38
HM220/230	101	32	SILVER CLIP 28 (SC28)	140	39
HM300/301/305	102	32	V32/V32SMS	141	39
HM350/350V	103	32	V43	142	39
HM550/560V	104	32	V53	143	39
HM580	105	32	MSB		
HM600/601	106	33	MS200	144	40
HM680	21	16	MS250	145	40
HM700/701/702/705	107	33	MS300	146	40
HM710/720	108	33	MS400	147	40
HM780	109	33	MS450	148	40
HM950/960	110	33	MS500	149	41
HM1000	111	33	MS600(NEW)	150	41
HM1500MV	112	34	MS700	151	41
HM2000MV	113	34	MS800	152	41
HM2100/2300	114	34	MS900	153	41
HM2500MV/2600	115	34	SAGA 1000	154	42
HM3000	116	34	SAGA 1500	155	42
HM4000	117	34	SAGA 2000	156	42
KUBOTA			NPK		
KXB 300/350	186	48	E-102	157	43
KXB 400/BTB400	187	48	E-106	158	43
KXB 450	188	48	E-200	159	43
KXB 500	189	48	E-201	160	43
KXB 600	190	48	E-202	161	43
LIFTON			E-203	162	43
LH70/80	303	65	E-204	163	44
LH110	304	65	E-205	164	44
LH170	305	65	E-206	165	44
LH360	306	65	E-207	166	44
LH500	307	65	E-208A	167	44
LH1000	308	65	E-210	168	44
MONTABERT			E-213	169	45
BRH40	118	35	E-216	170	45
BRH76/91	119	35	E-220	171	45
BRH125	120	35	E-225	172	45
BRH250/270	121	35	E-240A	173	45

Hammer Type & Tool Reference Index

Machine	Fig. No.	Page	Machine	Fig. No.	Page
NPK - contd.			OMAL		
GH10	174	45	OMAL 80	118	35
H-06X	175	46	OMAL 80S	216	53
H-08XA	176	46	OMAL 270	120	35
H-1XA	177	46	OMAL 500	121	35
H-2XA/E	178	46	OMAL 1000	122	35
H-3XA/E	179	46	OMD		
H-4X	180	46	OMD 8	118	35
H-6XA	181	47	OMD 30	120	35
H-7XA	182	47	OMD 50	121	35
H-8XA	183	47	OMD 100	122	35
H-10XB/E	184	47	PEL-JOB		
H-12X/E	185	47	MH90	216	53
OCM			MH95	217	53
OCM8	118	35	MH130/160	218	53
OCM25	120	35	MH180/260	219	53
OCM55	121	35	PROMOVE		
OCM100	122	35	P22	124	36
OCM130	125	36	PMV90/P3SH	118	35
O&K			PMV290/390/P12SH	120	35
H32	187	48	PMV690/P16SH	121	35
H45	188	48	PMV1000/P23SH	122	35
H65	189	48	PMV1390/P27SH	125	36
H85	190	48	RAMMER		
H120	192	49	S18/PICCOLO	186	48
H150	193	49	S21	187	48
H200	203	50	S22	188	48
H260	205	51	S23	189	48
H310	206	51	S25	190	48
H380	207	51	S26	191	48
H530	208	51	S27	192	49
H700	210	52	S29	193	49
OKADA			S52	194	49
OKB/UB 301	309	66	S54	195	49
OKB/UB 301SL	310	66	S55	196	49
OKB/UB 302	311	66	S56	197	49
OKB/UB 302A	312	66	S82	198	50
OKB/UB 303A	313	66	S83	199	50
OKB/UB 304	314	66	S84	200	50
OKB/UB 304B	315	66	S86	201	50
OKB/UB 305	316	66	E63	202	50
OKB/UB 308	317	66	E64	203	50
OKB/UB 310	318	66	E65	204	51
OKB/UB 312B	319	66	E66	205	51
OKB/UB 316	320	66	E68	206	51
OKB/UB 318	321	66	G80	207	51
UB 2	322	66	G90	208	51
UB 4	323	66	G100	209	51
UB 5	324	66	G110	210	52
UB8	325	66	G120	211	52
UB11	326	66	G130	212	52
UB14	327	66	M14	213	52
UB17/OKB17A2	328	66	M18	214	52

Hammer Type & Tool Reference Index

Machine	Fig. No.	Page	Machine	Fig. No.	Page
ROTAIR			STAR		
OL50	215	53	SH40	118	35
OL90 (WITH COLLAR)	216	53	SH91	81	28
OL 90/95	217	53	SH151	82	28
OL 130/160	218	53	SH200	83	28
OL 180/260	219	53	SH280	120	35
OL 250/330	220	53	SH281	84	28
SOCOMECH			SH560	121	35
DMS 50	221	54	SH561	86	29
DMS 95	222	54	SH990	122	35
DMS 160	223	54	SH991	87	29
DMS 220	224	54	SH1200	124	36
DMS 330	225	54	SH1400	125	36
DMS 430	226	54	SH1402	89	29
DMS740	227	55	TABE		
MD0 550	228	55	AGB 100/175/200	341	66
MD0 750	229	55	AGB 270/275/350/375	342	66
MD0 1450	230	55	AGB 400/475	343	66
MD0 1950	231	55	AGB 700/701/750	344	66
SOOSAN			AGB 1000/1300/1301	345	66
SB10	232	56	AGB 1600/1620	346	66
SB20	233	56	AGB 1800	347	66
SB30	234	56	TAKEUCHI		
SB40	235	56	TKB-31	261	62
SB43	236	56	TKB-51	262	62
SB45	237	56	TKB-71	263	62
SB50	238	57	TKB-101	264	62
SB60	239	57	TKB-201	265	62
SB81	240	57	TKB-301	266	63
SB100	241	57	TKB-401	267	63
SB121	242	57	TKB-801	268	63
SB130/140	243	58	TKB-1101	269	63
SB151	244	58	TKB-1401	270	63
STANLEY			TKB-1600	271	64
MB 125	329	66	TKB-2000	272	64
MB 156	330	66	TKB-3000	273	64
MB 250/256/350/356	331	66	TELEDYNE		
MB 506	235	56	TB100	245	59
MB 550	332	66	TB120/125	246	59
MB 656/675/695	333	66	TB180/225	247	59
MB 800/856	334	66	TB220/325	249	59
MB 1550	335	66	TB275	248	59
MB 1950/1975	336	66	TB400/425 /625	250	59
MB 2950/2975	337	66	TB700/725/750/825	251	60
MB 3950	338	66	TB830	255	60
MB20EX	237	56	TB900/925/975/1000/1025	252	60
MB30EX	238	57	TB980	256	61
MB40EX	239	57	TB1300/1425	253	60
MB50EX	240	57	TB1680	258	61
MB70EX	242	57	TB1825/2075	254	60
MB80EX	243	58	TB2580	260	61
MB100EX	244	58	TB2080	259	61

Hammer Type & Tool Reference Index

Machine	Fig. No.	Page	Machine	Fig. No.	Page
TOKU			VOLVO		
TNB 08E/1M	245	59	HB80	186	48
TNB 1E/2M	246	59	HB130	187	48
TNB 2E/3M	247	59	HB200	188	48
TNB 3E/4M	248	59	HB300	189	48
TNB 4E/5M	249	59	HB440	190	48
TNB 6E/7M	250	59	HB600	192	49
TNB 7E/10E	251	60	HB800	193	49
TNB 14E/16E	252	60	HB1100	202	50
TNB 22E/23E	253	60	HB1400	204	51
TNB 30E/31E	254	60	HB1700	206	51
TNB 100	255	60	HB2400	207	51
TNB 150	256	61	HB3200	208	51
TNB 190	257	61	HB3800	210	52
TNB 230	258	61	WIMMER		
TNB 310	259	61	W-220	144	40
TNB 400	260	61	W-330	146	40
TOPA			W-440	147	40
TOPA 70	348	66	W-550	149	41
TOPA 100	349	66	W-770	151	41
TOPA 200	350	66	W-880	152	41
TOPA 300	351	66	W-990	153	41
TOPA 500	352	66	ADDENDUM		
TOPA 1000	353	66	GEHL		
TOPA 1400	354	66	G50S	215	53
TOPA 1500	355	66	G95S	217	53
TOYO			G160S	218	53
THBB 31	261	62	G260S	219	53
THBB 51	262	62	G330S	220	53
THBB 71	263	62			
THBB 101	264	62			
THBB-201	265	62			
THBB 301	266	63			
THBB 401	267	63			
THBB 801	268	63			
THBB 1101	269	63			
THBB 1401	270	63			
THBB 1600	271	64			
THBB 2000	272	64			
THBB 3000	273	64			
VIBRARAM					
VRH-50	295	66			
VRH-60	296	66			
VRH-75	298	66			
VRH-90	299	66			
VRH-115	300	66			
VRH135	301	66			
VRH-145	302	66			

Figure
No.

TYPE	LENGTH MM	CATALOGUE NUMBER	WEIGHT KGS
------	--------------	---------------------	---------------

1

Atlas Copco PB110

Berco BB42, Chicago Pneumatic CP100, Krupp AT20

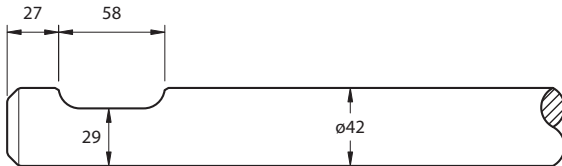

Point	470	KR41P0470	4
Chisel	470	KR41C0470	4

2

Atlas Copco PB160

Berco BB52, Chicago Pneumatic CP150, Krupp AT70

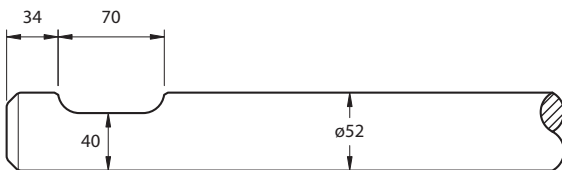

Point	600	KR42P0600	8
Chisel	600	KR42C0600	8

3

Atlas Copco PB210

Berco BB62, Chicago Pneumatic CP200, Krupp AT120

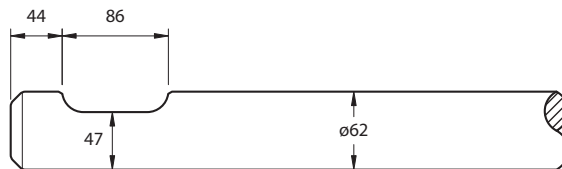

Point	700	KR43P0700	14
Chisel	700	KR43C0700	14

4

Atlas Copco PB310

Berco BB70, Chicago Pneumatic CP300, Krupp AT170

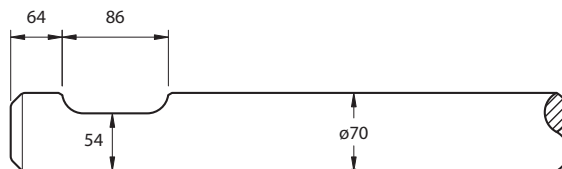

Point	750	KR44P0750	21
Chisel	750	KR44C0750	21

5

Atlas Copco PB420

Berco BB80, Chicago Pneumatic CP400/550, Krupp AT220, HM220/230

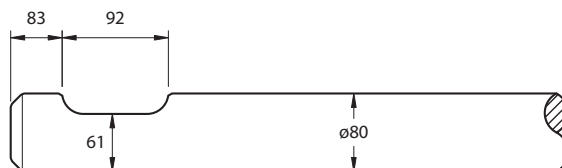

Point	900	KR34P0900	29
Chisel	900	KR34C0900	29

6

Atlas Copco SB50

Atlas Copco SBC60, Tex30H

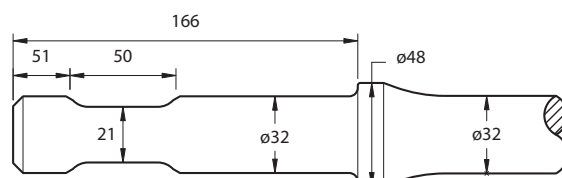

Point	430	AC21P0430	2
Chisel	430	AC21C0430	2

Figure
No.

TYPE	LENGTH MM	CATALOGUE NUMBER	WEIGHT KGS
------	--------------	---------------------	---------------

7

Atlas Copco SB100

Atlas Copco SBC115, TEX75H / 100H

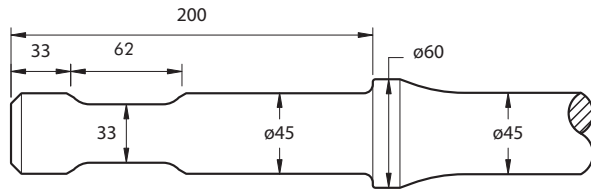

Point	550	AC10P0550	5
Chisel	550	AC10C0550	5

8

Atlas Copco SB150

Atlas Copco SBC255, TEX110H



Point	550	AC17P0550	7
Chisel	550	AC17C0550	7

9

Atlas Copco SB200

Atlas Copco SBC410, TEX180H

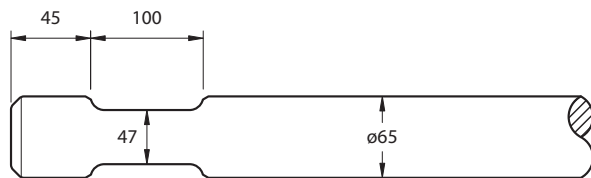

Point	600	AC18P0600	13
Chisel	600	AC18C0600	13

10

Atlas Copco SB300

Atlas Copco SBC610, SBC650

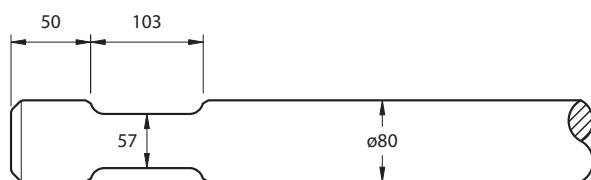

Point	800	AC22P0800	27
Chisel	800	AC22C0800	27

11

Atlas Copco SB300 Scaler

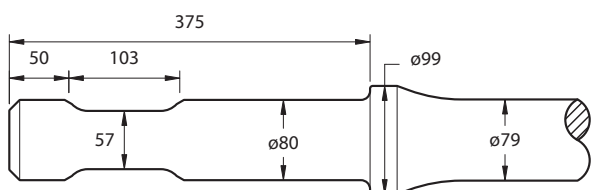

Blunt	800	AC23B2800	28
-------	-----	------------------	----

12

Atlas Copco Tex 250H

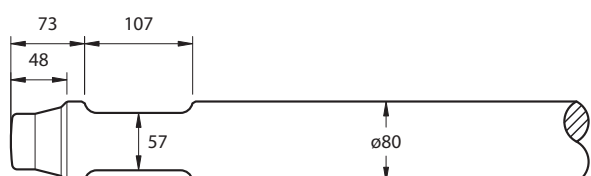

Point	800	AC12P0800	27
Chisel	800	AC12C0800	27

Figure
No.

TYPE	LENGTH MM	CATALOGUE NUMBER	WEIGHT KGS
------	--------------	---------------------	---------------

13

Atlas Copco Tex 250H Scaler

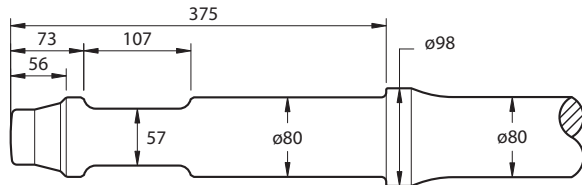

Blunt	800	AC19B0800	28
-------	-----	-----------	----

14

Atlas Copco SB450

Atlas Copco SBC800/850, Tex 400H

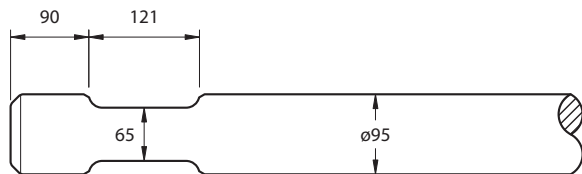

Point	840	AC20P0840	43
Chisel	840	AC20C0840	43

15

Atlas Copco HBC1100/1700

Atlas Copco Tex 600H, 700H, 900H

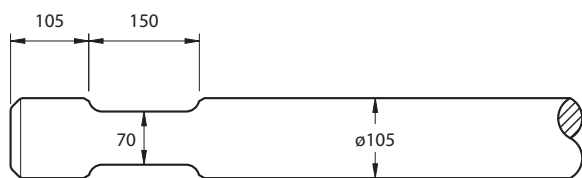

Point	900	AC14P0900	60
Chisel	900	AC14C0900	60
Blunt	900	AC14B0900	60

16

Atlas Copco HBC2500

Atlas Copco Tex 1400H

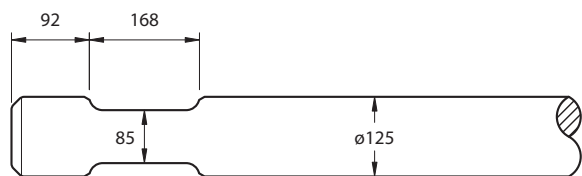

Point	1000	AC15P1000	95
Chisel	1000	AC15C1000	95
Blunt	1000	AC15B1000	95

17

Atlas Copco HBC4000

Atlas Copco Tex 1800H/2000H

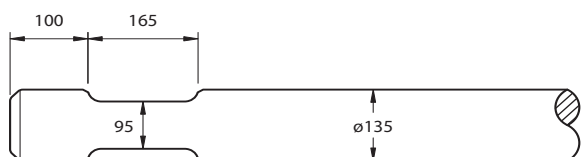

Point	1100	AC16P1100	119
Chisel	1100	AC16C1100	119
Blunt	1100	AC16B1100	119

18

Atlas Copco HBC6000

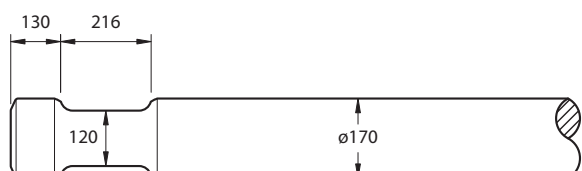

Point	1500	AC23P1500	245
Chisel	1500	AC23C1500	245
Blunt	1500	AC23B1500	245

Figure
No.

TYPE	LENGTH MM	CATALOGUE NUMBER	WEIGHT KGS
------	--------------	---------------------	---------------

19

Atlas Copco MB500

Krupp HM350

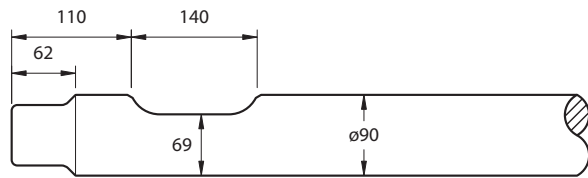

Point	900	KR32P0900	36
Chisel	900	KR32C0900	36

20

Atlas Copco MB700/MB800

Krupp HM580, Chicago Pneumatic CP750

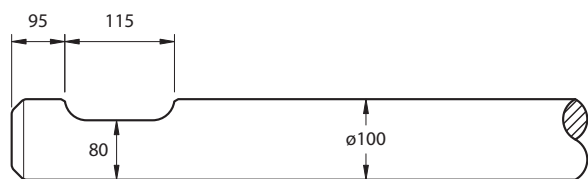

Point	1000	KR38P1000	55
Chisel	1000	KR38C1000	55
Blunt	1000	KR38B1000	55

21

Atlas Copco MB1000

Krupp HM680

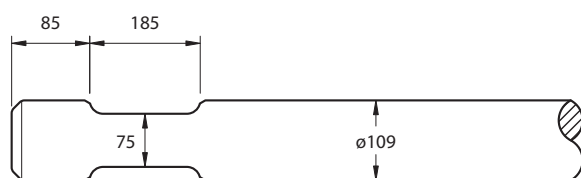

Point	1050	AC24P1050	61
Chisel	1050	AC24C1050	61
Blunt	1050	AC24B1050	61

22

Atlas Copco MB1200

Krupp HM780



Point	1150	KR39P1150	94
Chisel	1150	KR39C1150	94
Blunt	1150	KR39B1150	94

23

Atlas Copco MB1700

Krupp HM1000

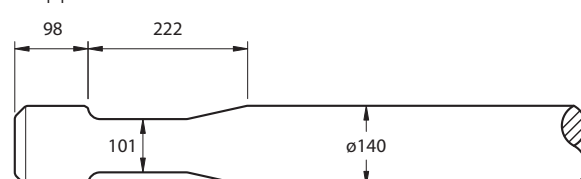

Point	1200	KR37P1200	137
Chisel	1200	KR37C1200	137
Blunt	1200	KR37B1200	137

24

Atlas Copco HB2200

Krupp HM1500, Chicago Pneumatic CP2250

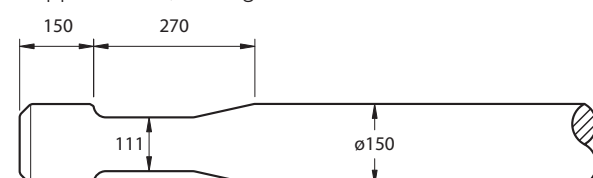

Point	1300	KR28P1300	178
Chisel	1300	KR28C1300	178
Blunt	1300	KR28B1300	178

Figure
No.

TYPE	LENGTH MM	CATALOGUE NUMBER	WEIGHT KGS
------	--------------	---------------------	---------------

25

Atlas Copco HB3000

Krupp HM2300, Chicago Pneumatic CP3050

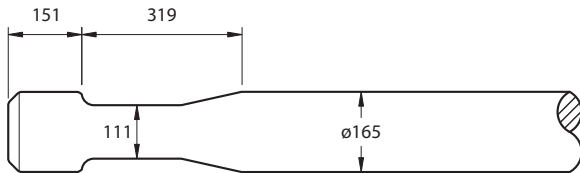

Point	1500	KR40P1500	223
Chisel	1500	KR40C1500	223
Blunt	1500	KR40B1500	223

26

Atlas Copco HB4200

Krupp HM2600, Chicago Pneumatic CP4250

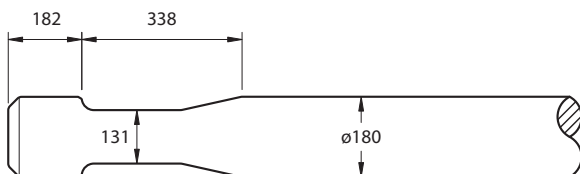

Point	1500	KR30P1500	300
Chisel	1500	KR30C1500	300
Blunt	1500	KR30B1500	300

27

Atlas Copco HB5800

Krupp HM3000

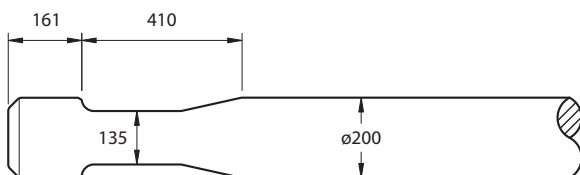

Point	1700	KR46P1700	405
Chisel	1700	KR46C1700	405
Blunt	1700	KR46B1700	405

28

Atlas Copco HB7000

Krupp HM4000

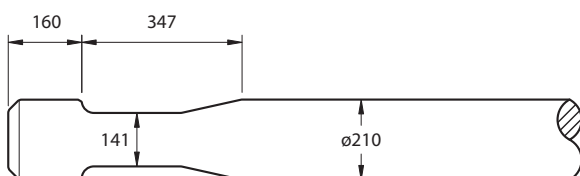

Point	1800	KR33P1800	458
Chisel	1800	KR33C1800	458
Blunt	1800	KR33B1800	458

Figure
No.

TYPE	LENGTH MM	CATALOGUE NUMBER	WEIGHT KGS
------	--------------	---------------------	---------------

29

Furukawa F1/HB1G



Point	400	FU21P0400	2
Chisel	400	FU21C0400	2

30

Furukawa F2/HB2G

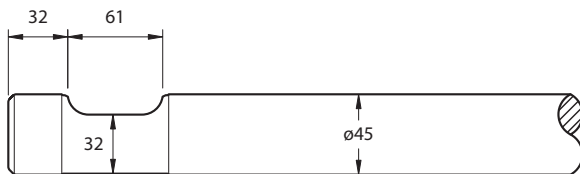

Point	450	FU22P0450	3
Chisel	450	FU22C0450	3

31

Furukawa F3

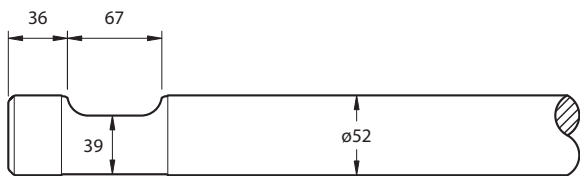

Point	525	FU32P0520	5
Chisel	525	FU32C0520	5

32

Furukawa F4

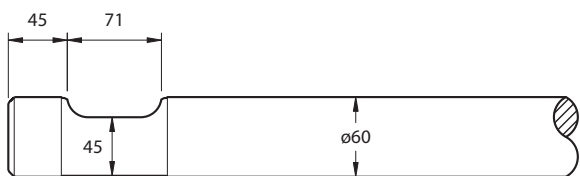

Point	560	FU33P0560	12
Chisel	560	FU33C0560	12

33

Furukawa F5

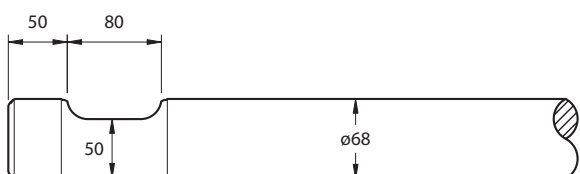

Point	600	FU34P0600	15
Chisel	600	FU34C0600	15

34

Furukawa F6

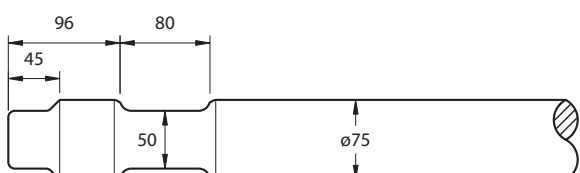

Point	730	FU35P0730	21
Chisel	730	FU35C073H	21

Figure
No.

TYPE	LENGTH MM	CATALOGUE NUMBER	WEIGHT KGS
------	--------------	---------------------	---------------

35

Furukawa F9

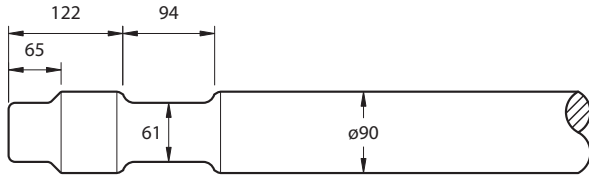

Point	850	FU37P0850	34
Chisel	850	FU37C0850	34

36

Furukawa F12

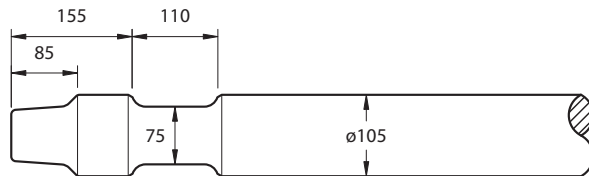

Point	1100	FU38P1100	72
Chisel	1100	FU38C1100	72
Blunt	1100	FU38B1100	72

37

Furukawa F19

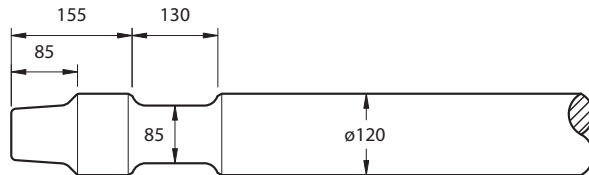

Point	1200	FU39P1200	97
Chisel	1200	FU39C1200	97
Blunt	1200	FU39B1200	97

38

Furukawa F22

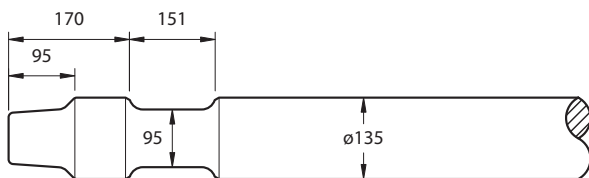

Point	1250	FU40P1250	125
Chisel	1250	FU40C1250	125
Blunt	1250	FU40B1250	125

39

Furukawa F27

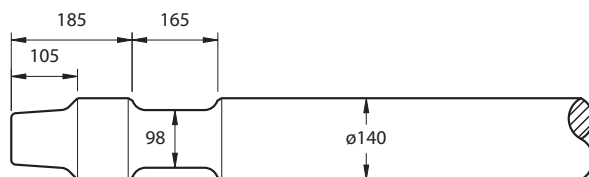

Point	1300	FU41P1300	136
Chisel	1300	FU41C1300	136
Blunt	1300	FU41B1300	136

40

Furukawa F35

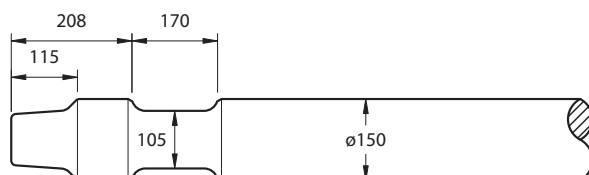

Point	1400	FU42P1400	192
Chisel	1400	FU42C1400	192
Blunt	1400	FU42B1400	192

Figure
No.

TYPE	LENGTH MM	CATALOGUE NUMBER	WEIGHT KGS
------	--------------	---------------------	---------------

41

Furukawa F45

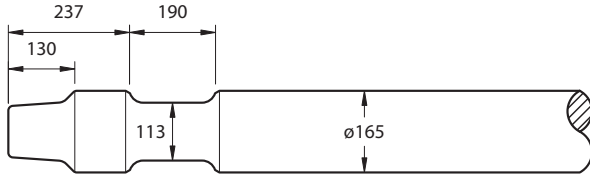

Point	1500	FU43P1500	231
Chisel	1500	FU43C1500	231
Blunt	1500	FU43B1500	231

42

Furukawa F70

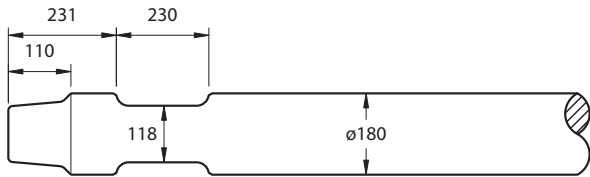

Point	1600	FU44P1600	270
Chisel	1600	FU44C1600	270
Blunt	1600	FU44B1600	270

43

Furukawa HB1G/ F1



Point	400	FU21P0400	3
Chisel	400	FU21C0400	3

44

Furukawa HB2G/F2

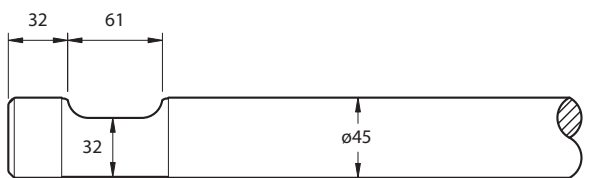

Point	450	FU22P0450	5
Chisel	450	FU22C0450	5

45

Furukawa HB3G

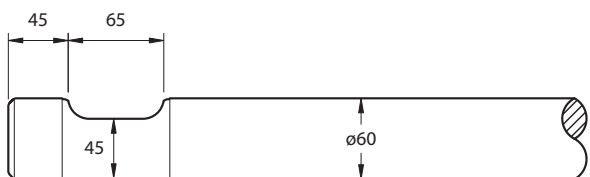

Point	560	FU23P0560	12
Chisel	560	FU23C0560	12

46

Furukawa HB5G



Point	640	FU24P0640	19
Chisel	640	FU24C0640	19

Figure
No.

TYPE	LENGTH MM	CATALOGUE NUMBER	WEIGHT KGS
------	--------------	---------------------	---------------

47

Furukawa HB8G

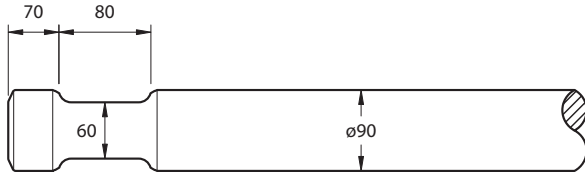

Point	750	FU25P0750	30
Chisel	750	FU25C0750	30

48

Furukawa HB10G



Point	1000	FU26P1000	65
Chisel	1000	FU26C1000	65

49

Furukawa HB15G



Point	1100	FU27P1100	90
Chisel	1100	FU27C1100	90

50

Furukawa HB20G

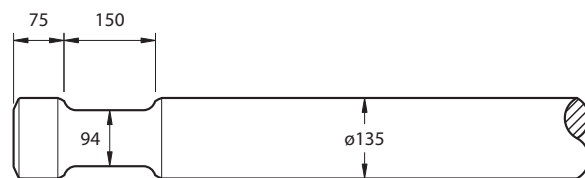

Point	1200	FU28P1200	125
Chisel	1200	FU28C1200	125

51

Furukawa HB30G

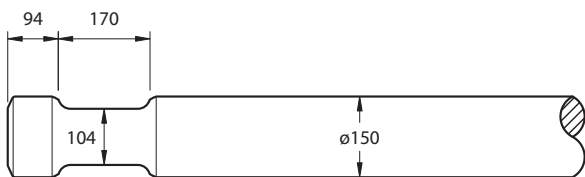

Point	1300	FU29P1300	165
Chisel	1300	FU29C1300	165

52

Furukawa HB40G

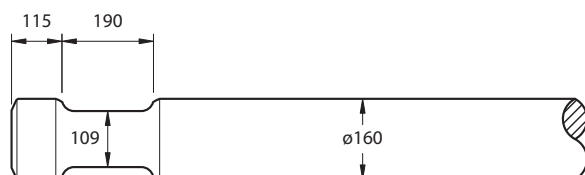

Point	1400	FU30P1400	200
Chisel	1400	FU30C1400	200

Figure
No.

TYPE	LENGTH MM	CATALOGUE NUMBER	WEIGHT KGS
------	--------------	---------------------	---------------

53

Hanwoo RHB 301-V

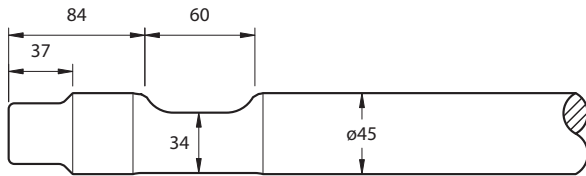

Point	480	HW11P0480	5
Chisel	480	HW11C0480	5

54

Hanwoo RHB 302/303-V

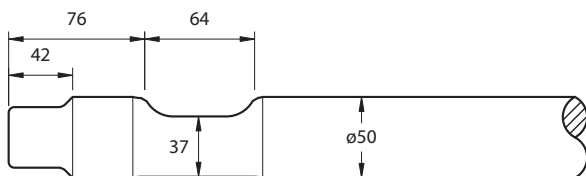

Point	490	HW12P0490	6
Chisel	490	HW12C0490	6

55

Hanwoo RHB 303

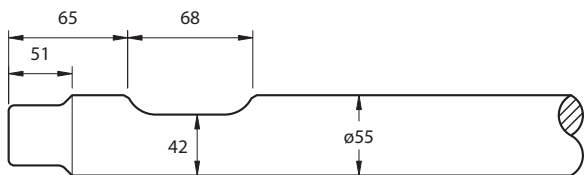

Point	500	HW13P0500	8
Chisel	500	HW13C0500	8

56

Hanwoo RHB 305-V

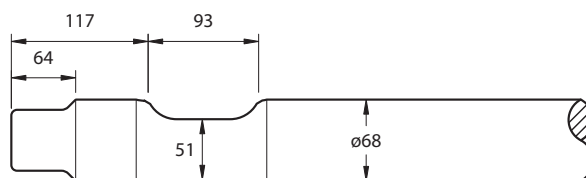

Point	760	HW14P0760	19
Chisel	760	HW14C0760	19

57

Hanwoo RHB 308-2/309

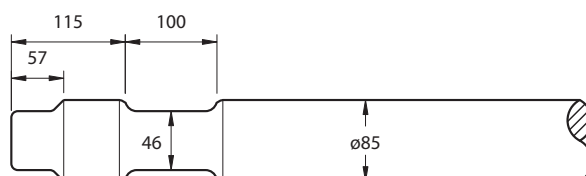

Point	900	HW15P0900	36
Chisel	900	HW15C0900	36

58

Hanwoo RHB 313-V

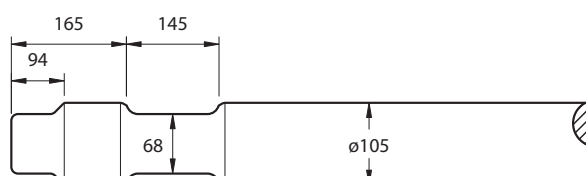

Point	1050	HW16P1050	61
Chisel	1050	HW16C1050	61

Figure
No.

TYPE	LENGTH MM	CATALOGUE NUMBER	WEIGHT KGS
------	--------------	---------------------	---------------

59

Hanwoo RHB 322-2/325

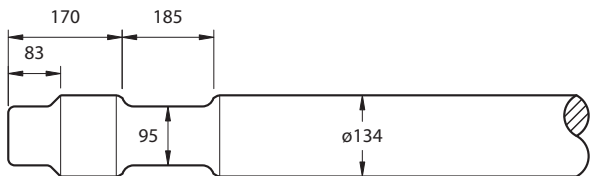

Point	1200	HW17P1200	116
Chisel	1200	HW17C1200	116
Blunt	1050	HW17B1050	104

60

Hanwoo RHB 328-2/330

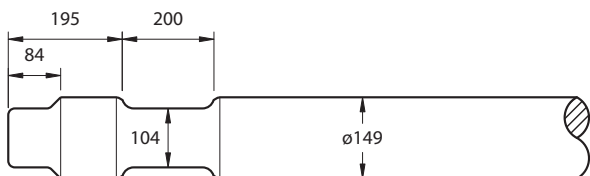

Point	1450	HW18P1450	180
Chisel	1450	HW18C1450	180
Blunt	1300	HW18B1300	164

61

Hanwoo RHB340

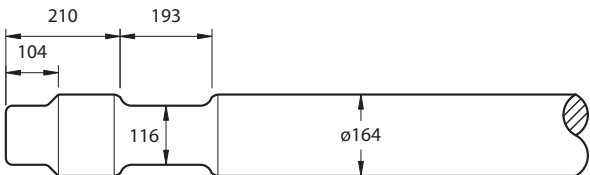

Point	1450	HW23P1450	215
Chisel	1450	HW23C1450	215
Blunt	1300	HW23B1300	195

Figure
No.

TYPE	LENGTH MM	CATALOGUE NUMBER	WEIGHT KGS
------	--------------	---------------------	---------------

62

Indeco HP150

Indeco UP121/150P, MES121/150, Euroram RM45

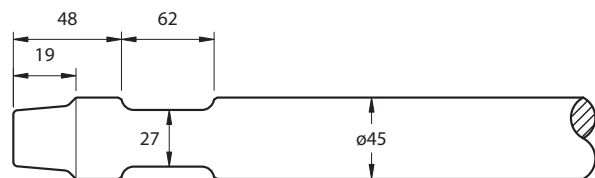

Point	440	IN23P0440	4
Chisel	440	IN23C0440	4

63

Indeco HP200

Indeco UP181/200P, MES180/181/200, Euroram RM48

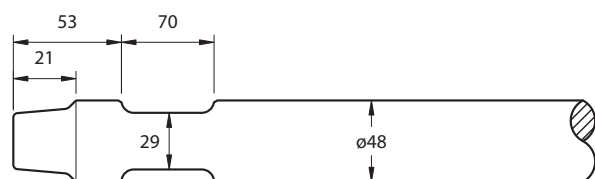

Point	550	IN17P0550	6
Chisel	550	IN17C0550	6

64

Indeco HP350

Indeco UP301/350P/351P, MES 300/301/350/351, Euroram RM56

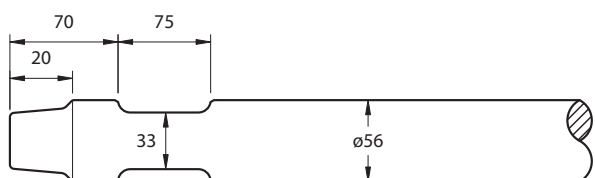

Point	600	IN18P0600	10
Chisel	600	IN18C0600	10

65

Indeco HP500

Indeco HB5, UP462/521/550P, MES 452/462/521/550, Euroram RM65

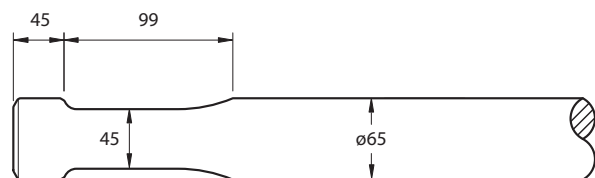

Point	650	IN11P0650	15
Chisel	650	IN11C0650	15

66

Indeco HP600

Indeco UP553, MES 553, Euroram RM75

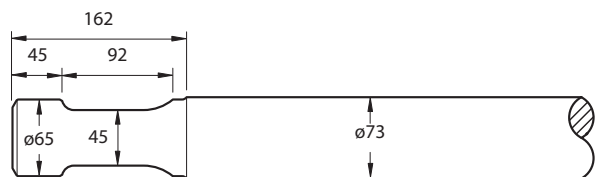

Point	680	IN29P0680	19
Chisel	680	IN29C0680	19

67

Indeco HB8

Euroram RM80

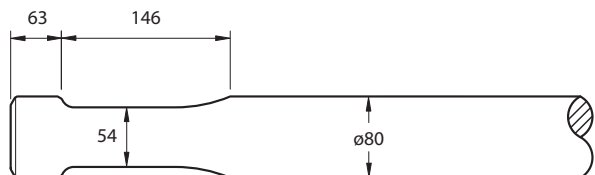

Point	700	IN12P0700	24
Chisel	700	IN12C0700	24

Figure
No.

TYPE	LENGTH MM	CATALOGUE NUMBER	WEIGHT KGS
------	--------------	---------------------	---------------

68

Indeco HP700

Indeco UP621/650P, MES 601/621/650

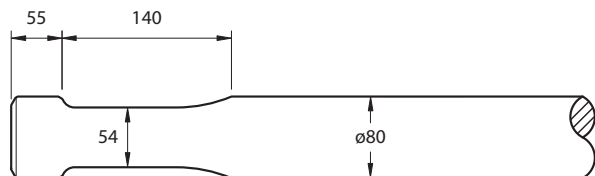

Point	650	IN19P0650	24
Chisel	650	IN19C0650	24

69

Indeco HP900

Indeco UP900

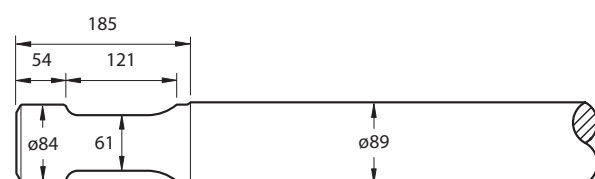

Point	700	IN31P0700	30
Chisel	700	IN31C0700	30

70

Indeco HP1200

Indeco HB12, UP1200, MES 1200, Euroram RM85/90

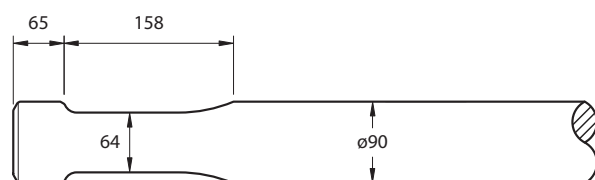

Point	800	IN13P0800	33
Chisel	800	IN13C0800	33

71

Indeco HP1500

Indeco HB19, UP1500, MES 1500, Euroram RM110

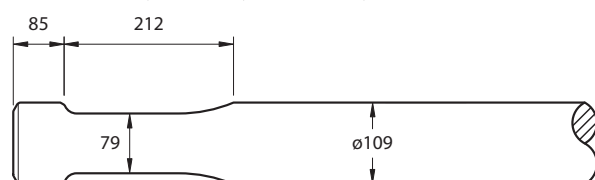

Point	900	IN15P0900	55
Chisel	900	IN15C0900	55
Blunt	800	IN15B0800	49

72

Indeco HP1800

Indeco UP1750, MES 1750/1800, Euroram RM115



Point	1000	IN27P1000	75
Chisel	1000	IN27C1000	75
Blunt	900	IN27B0900	68

73

Indeco HP2000

Indeco HB27, UP2000, MES 2000, Euroram RM120



Point	1000	IN16P1000	87
Chisel	1000	IN16C1000	87
Blunt	900	IN16B0900	78

Figure
No.

TYPE	LENGTH MM	CATALOGUE NUMBER	WEIGHT KGS
------	--------------	---------------------	---------------

74

Indeco HP2500

Indeco UP2500, MES 2500, Euroram RM130

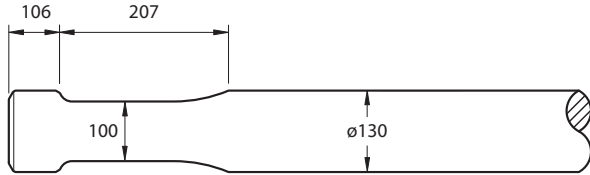

Point	1050	IN20P1050	101
Chisel	1050	IN20C1050	101
Blunt	950	IN20B0950	91

75

Indeco HP3000

Indeco UP3000, MES 3000, Euroram RM140

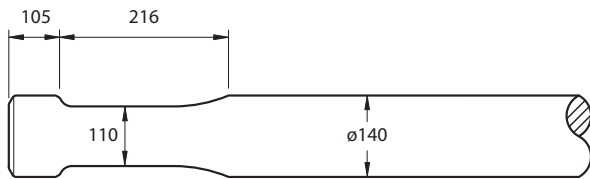

Point	1100	IN24P1100	115
Chisel	1100	IN24C1100	115
Blunt	1000	IN24B1000	115

76

Indeco HP3500

Indeco UP3500, MES 3500, Euroram RM145

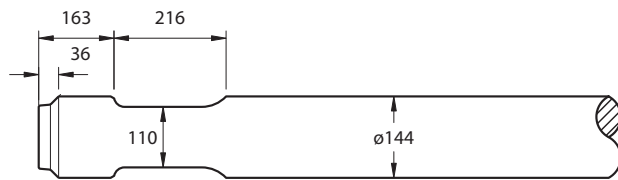

Point	1170	IN21P1170	130
Chisel	1170	IN21C1170	130
Blunt	1070	IN21B1070	119

77

Indeco HP4000

Indeco UP4000, MES 4000, Euroram RM150

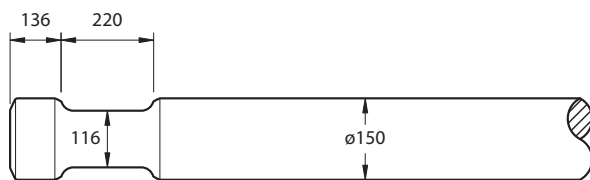

Point	1250	IN28P1250	172
Chisel	1250	IN28C1250	172
Blunt	1150	IN28B1150	158

Figure
No.

TYPE	LENGTH MM	CATALOGUE NUMBER	WEIGHT KGS
------	--------------	---------------------	---------------

78

Indeco HP5000

Indeco UP5000, MES 5000, Euroram RM160

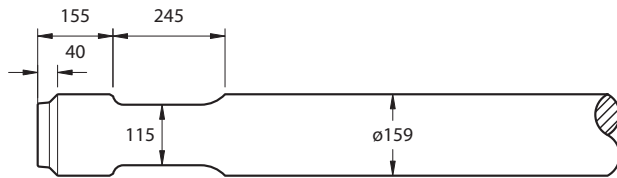

Point	1320	IN22P1320	203
Chisel	1320	IN22C1320	203
Blunt	1170	IN22B1170	180

79

Indeco HP7000

Indeco UP7000, MES 7000, Euroram RM180

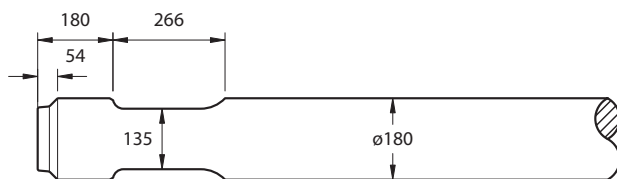

Point	1450	IN25P1450	290
Chisel	1450	IN25C1450	290
Blunt	1300	IN25B1300	260

80

Indeco HP9000

Indeco UP8500, MES 8500, Euroram RM195

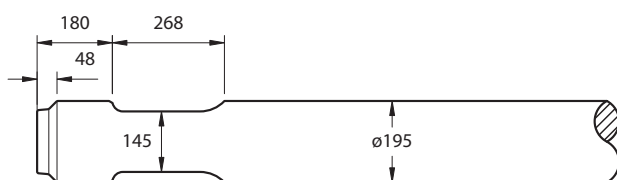

Point	1530	IN26P1530	360
Chisel	1530	IN26C1530	360
Blunt	1380	IN26B1380	325

Figure
No.

TYPE	LENGTH MM	CATALOGUE NUMBER	WEIGHT KGS
------	--------------	---------------------	---------------

81

Italdem GK 85/86

Star SH91

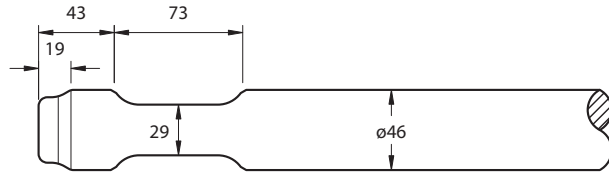

Point	450	IT24P0450	4
Chisel	450	IT24C0450	4

82

Italdem GK 160/161

Star SH151

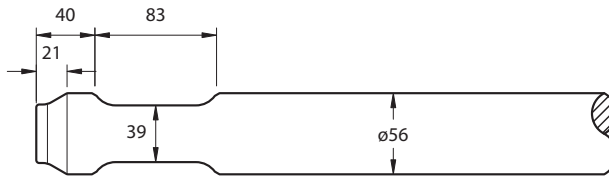

Point	500	IT25P0500	8
Chisel	500	IT25C0500	8

83

Italdem GK 211

Star SH200

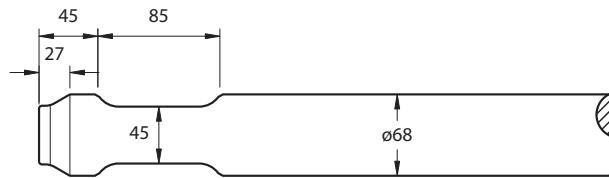

Point	620	IT27P0620	15
Chisel	620	IT27C0620	15

84

Italdem GK 290/291

Star SH281

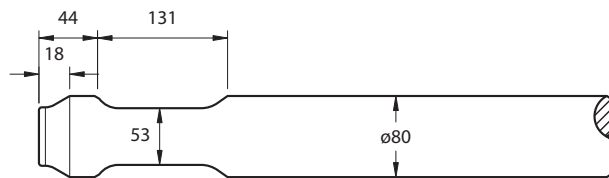

Point	660	IT28P0660	23
Chisel	660	IT28C0660	23

85

Italdem GK 360/361

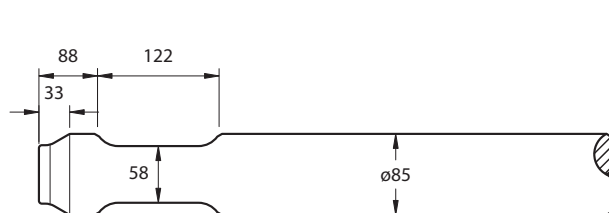

Point	700	IT29P0700	28
Chisel	700	IT29C0700	28

Figure
No.

TYPE	LENGTH MM	CATALOGUE NUMBER	WEIGHT KGS
------	--------------	---------------------	---------------

86

Italdem GK 600/610

Star SH561

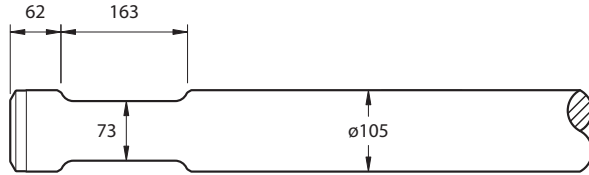

Point	900	IT30P0900	60
Chisel	900	IT30C0900	60

87

Italdem GK 950/960

Star SH991

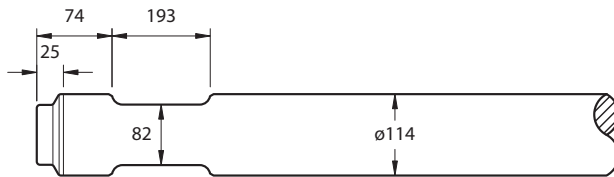

Point	1050	IT31P1050	79
Chisel	1050	IT31C1050	79
Blunt	950	IT31B0950	72

88

Italdem GK 1350

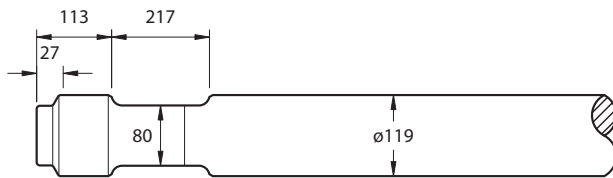

Point	1100	IT32P1100	90
Chisel	1100	IT32C1100	90
Blunt	1000	IT32B1000	82

89

Italdem GK 1351S

Star SH1402



Point	1150	IT36P1150	94
Chisel	1150	IT36C1150	94
Blunt	1050	IT36B1050	86

90

Italdem GK 1600

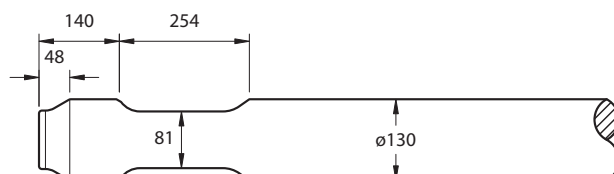

Point	1200	IT33P1200	113
Chisel	1200	IT33C1200	113
Blunt	1100	IT33B1100	104

Figure
No.

TYPE	LENGTH MM	CATALOGUE NUMBER	WEIGHT KGS
------	--------------	---------------------	---------------

91

Italdem GK 2400

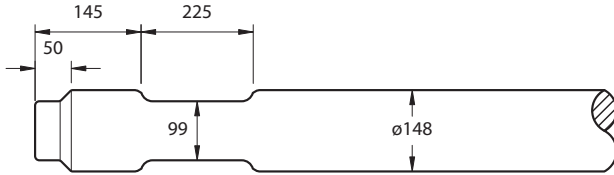

Point	1350	IT34P1350	185
Chisel	1350	IT34C1350	185
Blunt	1200	IT34B1200	165

92

Italdem GK 3400/3500

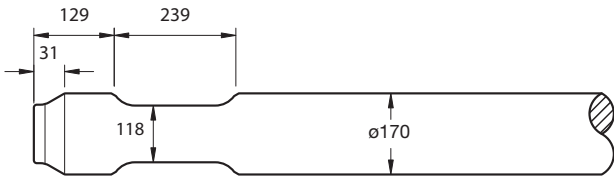

Point	1450	IT35P1450	238
Chisel	1450	IT35C1450	238
Blunt	1300	IT35B1300	214

93

Italdem GK 3800

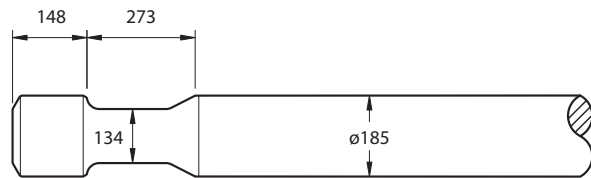

Point	1350	IT37P1350	285
Chisel	1350	IT37C1350	285
Blunt	1250	IT37B1250	265

Figure
No.

TYPE	LENGTH MM	CATALOGUE NUMBER	WEIGHT KGS
------	--------------	---------------------	---------------

94

Krupp HM50/55

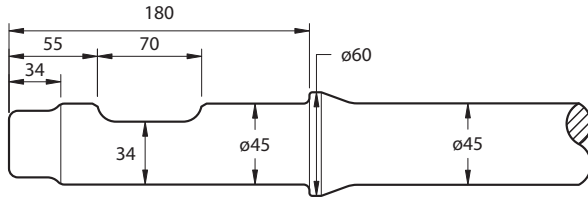

Point	580	KR11P0580	5
Chisel	580	KR11C0580	5

95

Krupp HM60V

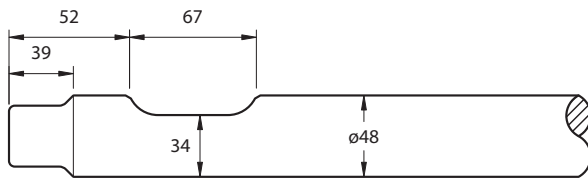

Point	500	KR35P0500	6
Chisel	500	KR35C0500	6

96

Krupp HM60/75

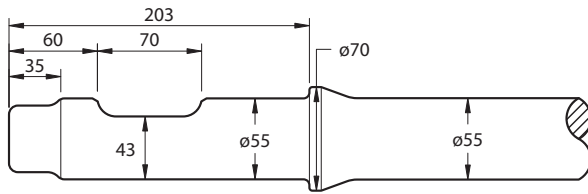

Point	600	KR12P0600	9
Chisel	600	KR12C0600	9

97

Krupp HM85/90/90V

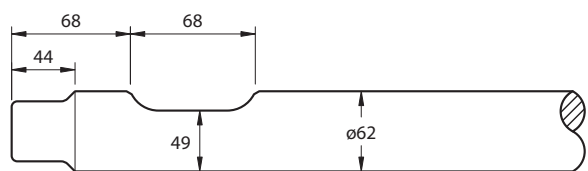

Point	600	KR31P0600	14
Chisel	600	KR31C0600	14

98

Krupp HM130/140V

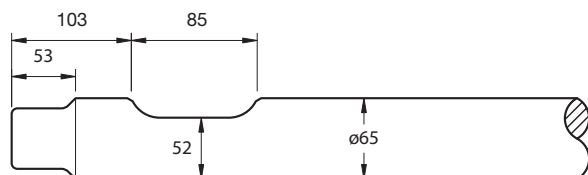

Point	780	KR14P0780	18
Chisel	780	KR14C0780	18

99

Krupp HM185/190V

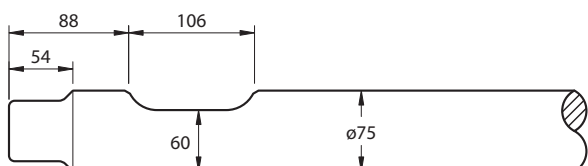

Point	800	KR15P0800	24
Chisel	800	KR15C0800	24

Figure
No.

TYPE	LENGTH MM	CATALOGUE NUMBER	WEIGHT KGS
------	--------------	---------------------	---------------

100

Krupp HM200

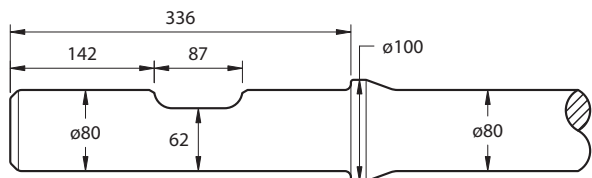

Point	835	KR16P0840	29
Chisel	835	KR16C0840	29

101

Krupp HM220/230

Krupp AT220, Chicago Pneumatic CP400/550, Berco BB80

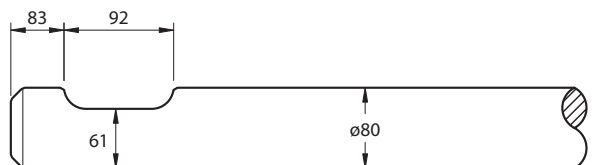

Point	900	KR34P0900	29
Chisel	900	KR34C0900	29

102

Krupp HM300/301/305

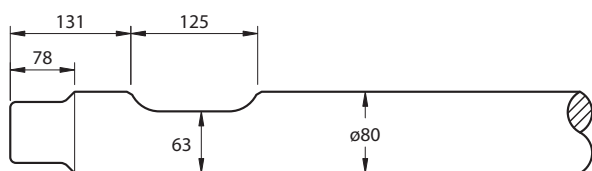

Point	900	KR17P0900	30
Chisel	900	KR17C0900	30

103

Krupp HM350/350V

Atlas Copco MB500

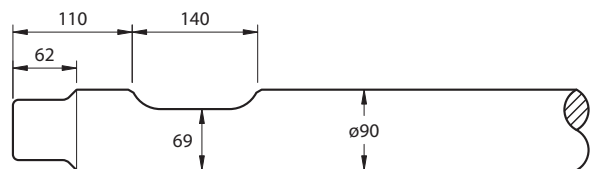

Point	900	KR32P0900	36
Chisel	900	KR32C0900	36

104

Krupp HM550/560V

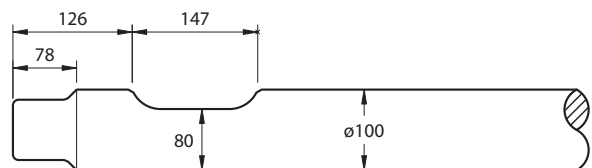

Point	1000	KR19P1000	55
Chisel	1000	KR19P1000	55

105

Krupp HM580

Atlas Copco MB800, Chicago Pneumatic CP750

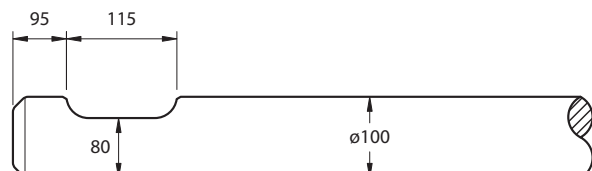

Point	1000	KR38P1000	55
Chisel	1000	KR38P1000	55

Figure
No.

TYPE	LENGTH MM	CATALOGUE NUMBER	WEIGHT KGS
------	--------------	---------------------	---------------

106

Krupp HM600/601

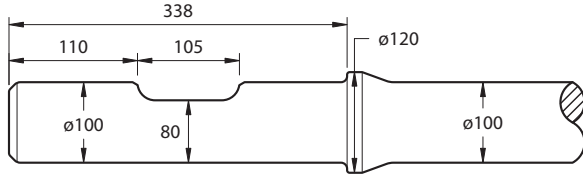

Point	1000	KR20P1000	56
Chisel	1000	KR20P1000	56

107

Krupp HM700/701/702/705

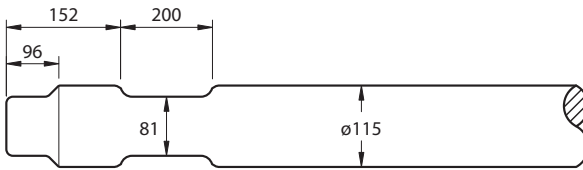

Point	1150	KR21P1150	86
Chisel	1150	KR21C1150	86
Blunt	1050	KR21B1050	79

108

Krupp HM710/720

Chicago Pneumatic CP1150

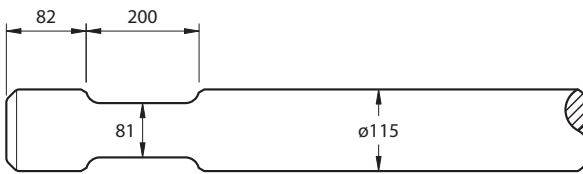

Point	1080	KR22P1080	82
Chisel	1080	KR22C1080	82
Blunt	1000	KR22B1000	76

109

Krupp HM780

Atlas Copco MB1200

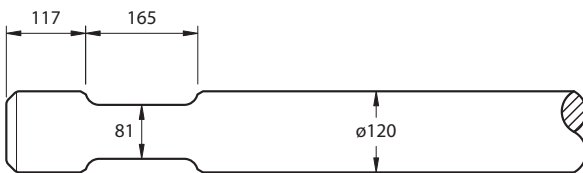

Point	1150	KR39P1150	94
Chisel	1150	KR39C1150	94
Blunt	1050	KR39B1050	86
Blunt	1150	KR39B1150	94

110

Krupp HM950/960

Chicago Pneumatic CP1650

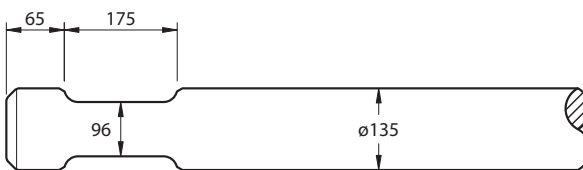

Point	1080	KR25P1080	110
Point	1350	KR25C1350	137
Chisel	1080	KR25C1080	110
Chisel	1350	KR25C1350	137
Blunt	1080	KR25B1080	110

111

Krupp HM1000

Atlas Copco MB1700

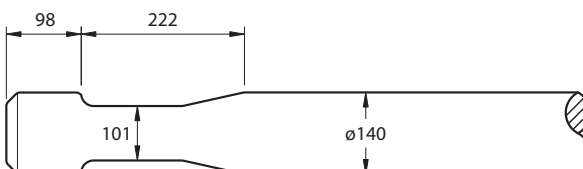

Point	1200	KR37P1200	137
Chisel	1200	KR37C1200	137
Blunt	1100	KR37B1100	126

Figure
No.

TYPE	LENGTH MM	CATALOGUE NUMBER	WEIGHT KGS
------	--------------	---------------------	---------------

112

Krupp HM1500MV

Atlas Copco HB2200, Chicago Pneumatic CP2250

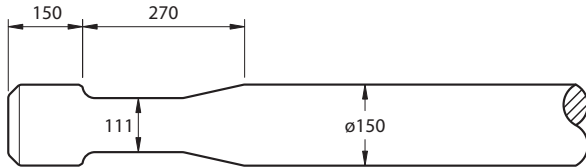

Point	1300	KR28P1300	178
Chisel	1300	KR28C1300	178
Blunt	1150	KR28B1150	158

113

Krupp HM2000MV

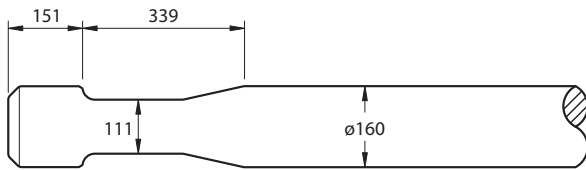

Point	1400	KR29P1400	220
Chisel	1400	KR29C1400	220
Blunt	1250	KR29B1250	197

114

Krupp HM2100/2300

Atlas Copco HB3000, Chicago Pneumatic CP3050

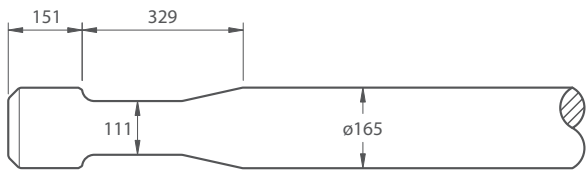

Point	1500	KR40P1500	223
Chisel	1500	KR40C1500	223
Blunt	1350	KR40B1350	201

115

Krupp HM2500/2600MV

Atlas Copco HB4200, Chicago Pneumatic CP4250

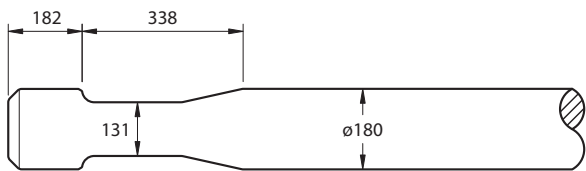

Point	1500	KR30P1500	300
Chisel	1500	KR30C1500	300
Blunt	1350	KR30B1350	270

116

Krupp HM3000

Atlas Copco HB5800

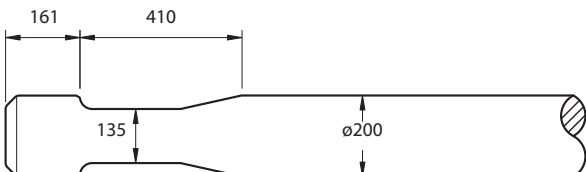

Point	1700	KR46P1700	405
Chisel	1700	KR46C1700	405
Blunt	1500	KR46B1500	358

117

Krupp HM4000

Atlas Copco HB7000



Point	1800	KR33P1800	458
Chisel	1800	KR33C1800	458
Blunt	1600	KR33B1600	408

Figure
No.

TYPE	LENGTH MM	CATALOGUE NUMBER	WEIGHT KGS
------	--------------	---------------------	---------------

118

Montabert BRH40

Idromeccanica IMI85, Italdem K80, OCM 8, Omal 80, OMD 8, Promove PMV90/P3SH, Star SH40

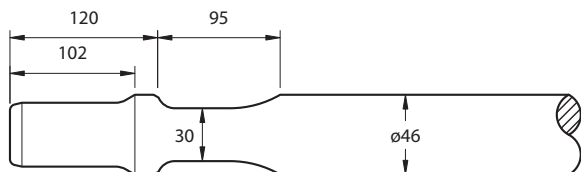

Point	500	MB11P0500	5
Point	700	MB11P0700	7
Chisel	500	MB11C0500	5
Chisel	700	MB11C0700	7

119

Montabert BRH76/91

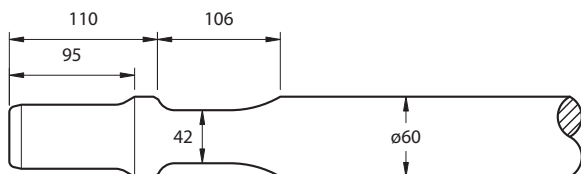

Point	550	MB12P0550	11
Chisel	550	MB12C0550	11

120

Montabert BRH125

Idromeccanica IMI260, Italdem K270, OCM 25, Omal 270, OMD 30, Promove PMV290/390/P12SH, Star SH280

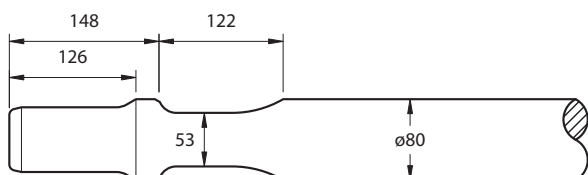

Point	650	MB13P0650	21
Point	760	MB13P0650	24
Point	950	MB13P0950	30
Chisel	650	MB13C0650	21
Chisel	760	MB13C0760	24
Chisel	950	MB13C0950	30

121

Montabert BRH250/270

Idromeccanica IMI600, Italdem K550, OCM 55, Omal 500, OMD 50, Promove PMV690/P16SH, Star SH560

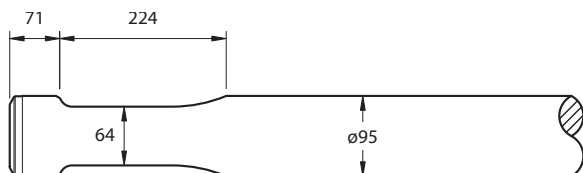

Point	850	MB14P0850	43
Point	1000	MB14P1000	52
Chisel	850	MB14C0850	43
Chisel	1000	MB14C1000	52

122

Montabert BRH501/570

Idromeccanica IMI1000, Indeco MES1750, Italdem K1000, OCM 100, Omal 1000, OMD 100, Promove PMV 1000/P23SH, Star SH990

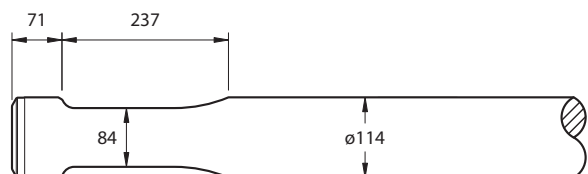

Point	1000	MB15P1000	76
Point	1300	MB15P1300	95
Chisel	1000	MB15C1000	76
Chisel	1300	MB15C1300	95
Blunt	1000	MB15B1000	76

Figure
No.

TYPE	LENGTH MM	CATALOGUE NUMBER	WEIGHT KGS
------	--------------	---------------------	---------------

123

Montabert BRH620

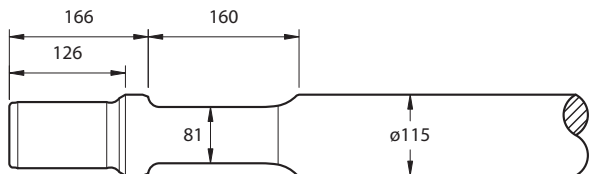

Point	1000	MB16P1000	75
Chisel	1000	MB16P1000	75

124

Montabert BRH625/900

Italdem K1030, Promove P22, Star SH1200

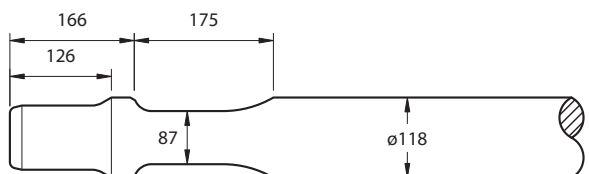

Point	1000	MB17P1000	78
Point	1150	MB17P1150	89
Chisel	1000	MB17C1000	78
Chisel	1150	MB17C1150	89
Blunt	1000	MB17B1000	78

125

Montabert BRH750

Italdem K1300, OCM130, Promove PMV1390/P27SH, Star SH1400

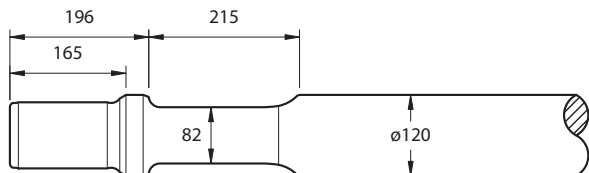

Point	1100	MB18P1100	93
Chisel	1100	MB18C1100	93
Blunt	1000	MB18B1000	85

126

Montabert 30

Bobcat B300

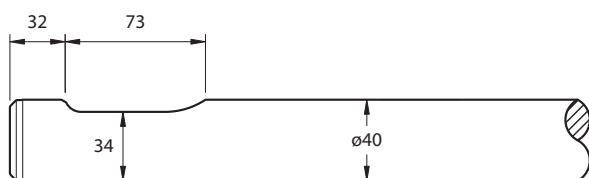

Point	410	MB35P0410	3
Chisel	410	MB35C0410	3

127

Montabert 50/50SMS

Bobcat B500

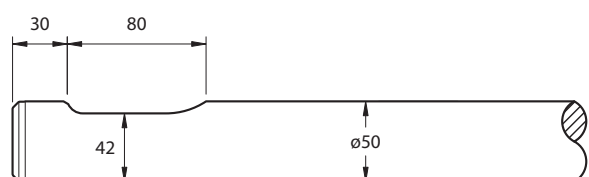

Point	430	MB33P0430	6
Point	630	MB33P0630	8
Chisel	430	MB33C0430	6
Chisel	630	MB33C0630	8

Figure
No.

TYPE	LENGTH MM	CATALOGUE NUMBER	WEIGHT KGS
------	--------------	---------------------	---------------

128

Montabert 70/70SMS

Bobcat B700

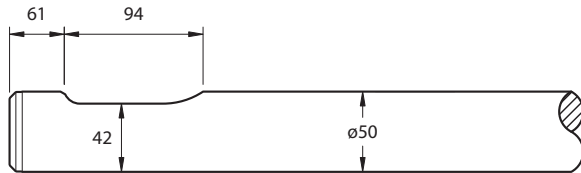

Point	510	MB34P0510	7
Point	710	MB34P0710	9
Chisel	510	MB34C0510	7
Chisel	710	MB34C0710	9

129

Montabert 85/85SMS/90/90SMS

Bobcat B850/B950



Point	620	MB37P0620	12
Chisel	620	MB37C0620	12

130

Montabert 125SX

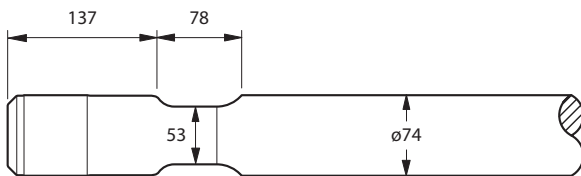

Point	750	MB40P0750	22
Chisel	750	MB40C0750	22

131

Montabert 140/140SMS/150/150SMS

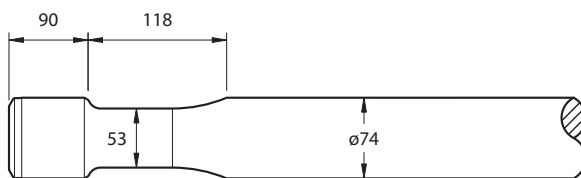

Point	740	MB36P0740	22
Point	950	MB36P0950	28
Chisel	740	MB36C0740	22
Chisel	950	MB36C0950	28

132

Montabert 300/300MS

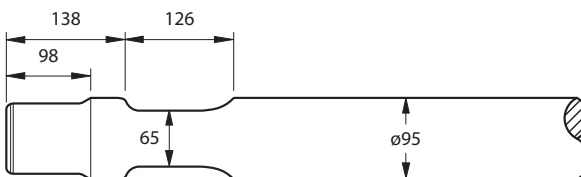

Point	850	MB39P0850	43
Chisel	850	MB39C0850	43

133

Montabert 700/700SMS

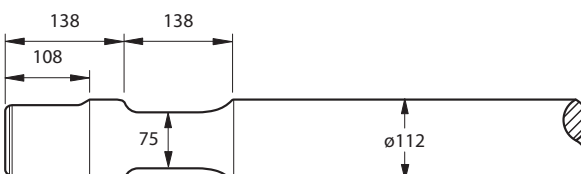

Point	1000	MB25P1000	70
Chisel	1000	MB25C1000	70

Figure
No.

TYPE	LENGTH MM	CATALOGUE NUMBER	WEIGHT KGS
------	--------------	---------------------	---------------

134

Montabert 900/900MS/BRH625

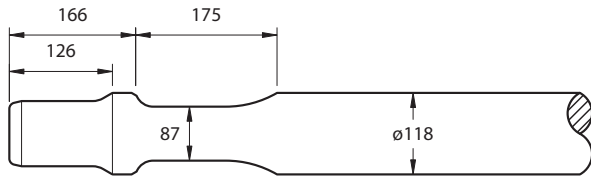

Point	1000	MB17P1000	78
Point	1150	MB17P1150	89
Chisel	1000	MB17C1000	78
Chisel	1150	MB17C1150	89
Blunt	1000	MB17B1000	78

135

Montabert V1200/V1200MS/V32/V32MS

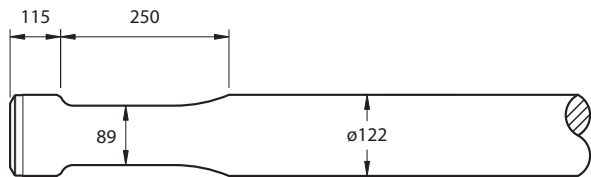

Point	1100	MB21P1100	100
Point	1300	MB21P1300	118
Chisel	1100	MB21C1100	100
Chisel	1300	MB21C1300	118
Blunt	1100	MB21B1100	100

136

Montabert Silver Clip 08 (SC08)

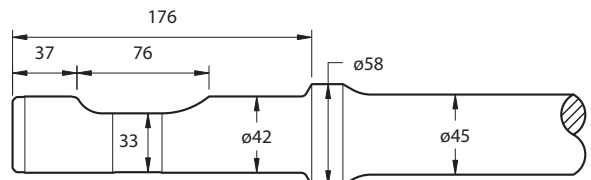

Point	455	MB46P0460	4
Chisel	455	MB46C0460	4
Pyramid Pt	455	MB46PP0460	4

137

Montabert Silver Clip 12 (SC12)

Bobcat 580

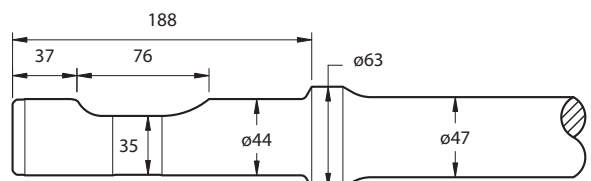

Point	475	MB41P0480	5
Chisel	475	MB41C0480	5
Pyramid Pt	475	MB41PP0480	5

138

Montabert Silver Clip 16 (SC16)

Bobcat 680

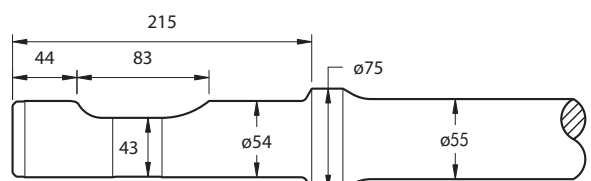

Point	550	MB43P0550	9
Chisel	550	MB43C0550	9
Pyramid Pt	550	MB43PP0550	9

139

Montabert Silver Clip 22 (SC22)

Bobcat 880

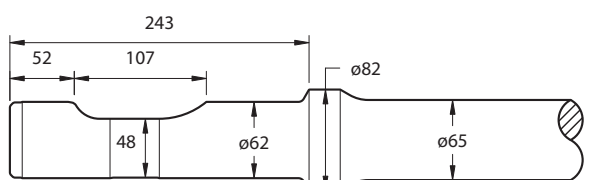

Point	580	MB44P0580	13
Chisel	580	MB44C0580	13
Pyramid Pt	580	MB44PP0580	13

Figure
No.

TYPE	LENGTH MM	CATALOGUE NUMBER	WEIGHT KGS
------	--------------	---------------------	---------------

140

Montabert Silver Clip 28 (SC28)

Bobcat 980

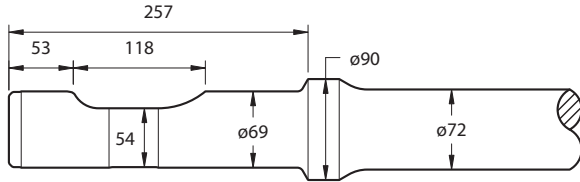

Point	620	MB42P0620	18
Chisel	620	MB42C0620	18
Pyramid Pt	620	MB42PP0620	18

141

Montabert V32/V32MS/V1200

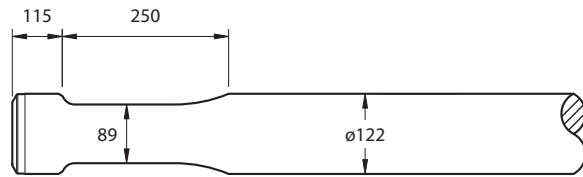

Point	1100	MB21P1100	100
Point	1300	MB21P1300	118
Chisel	1100	MB21C1100	100
Chisel	1300	MB21C1300	118
Blunt	1100	MB21B1100	100

142

Montabert V43

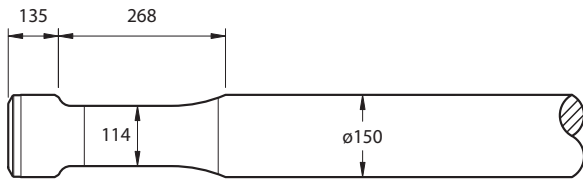

Point	1250	MB22P1250	172
Chisel	1250	MB22C1250	172
Blunt	1100	MB22B1100	152

143

Montabert V53

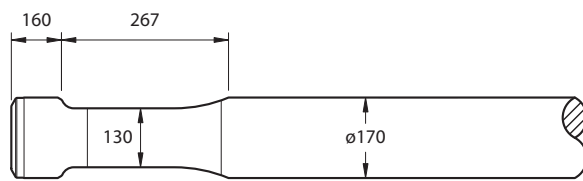

Point	1400	MB24P1400	230
Chisel	1400	MB24C1400	230
Blunt	1250	MB24B1250	206

Figure
No.

TYPE	LENGTH MM	CATALOGUE NUMBER	WEIGHT KGS
------	--------------	---------------------	---------------

144

MSB MS200

Wimmer W-220

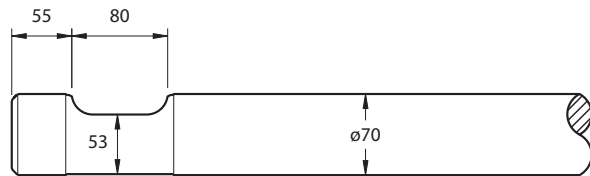

Point	680	MS12P0680 MS12C0680	20
Chisel	680		20

145

MSB MS250

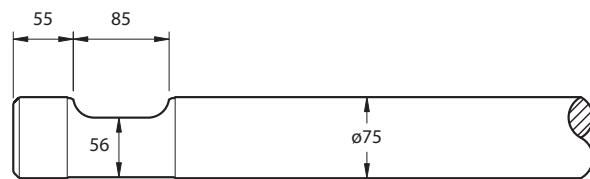

Point	700	MS22P0730 MS22C0730	21
Chisel	700		21

146

MSB MS300

Wimmer W-330

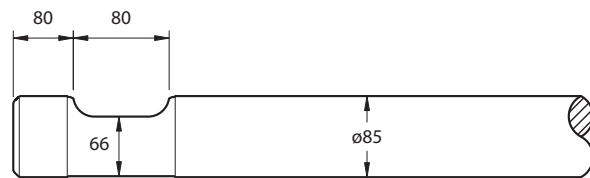

Point	790	MS13P0790 MS13C0790	28
Chisel	790		28

147

MSB MS400

Wimmer W-440

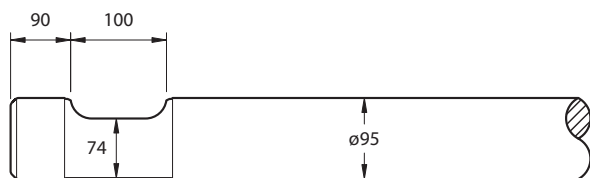

Point	920	MS14P0920 MS14C0920	48
Chisel	920		48

148

MSB MS450

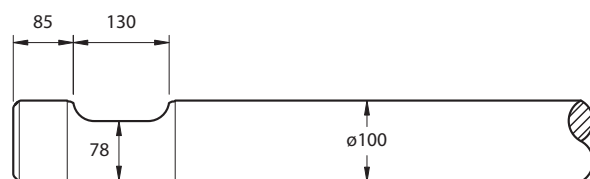

Point	920	MS23P0920 MS23C0920	52
Chisel	920		52

Figure
No.

TYPE	LENGTH MM	CATALOGUE NUMBER	WEIGHT KGS
------	--------------	---------------------	---------------

149

MSB MS500

Wimmer W-550

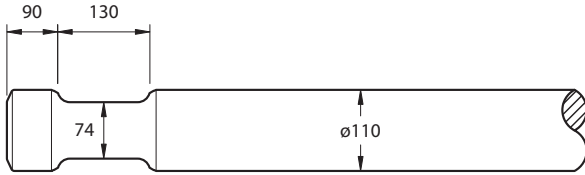

Point	1050	MS15P1050	64
Chisel	1050	MS15C1050	64

150

MSB MS600 (New)

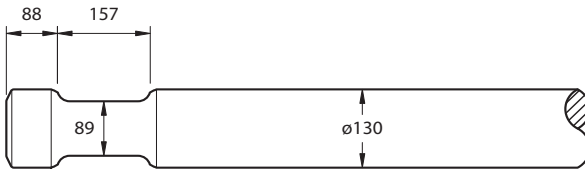

Point	1200	MS20P1200	111
Chisel	1200	MS20C1200	111
Blunt	1100	MS20B1100	102

151

MSB MS700

Wimmer W-770

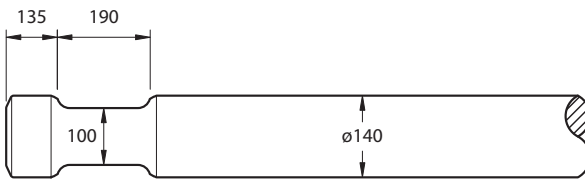

Point	1200	MS21P1200	137
Chisel	1200	MS21C1200	137
Blunt	1100	MS21B1100	126

152

MSB MS800

Wimmer W-880



Point	1400	MS24P1400	206
Chisel	1400	MS24C1400	206
Blunt	1250	MS24B1250	184

153

MSB MS900

Wimmer W-990

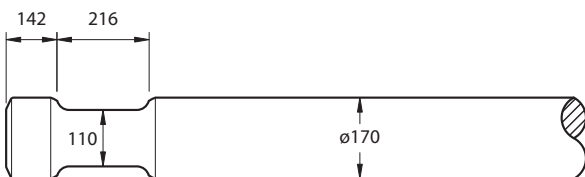

Point	1450	MS19P1450	240
Chisel	1450	MS19C1450	240
Blunt	1300	MS19B1300	215

Figure
No.

TYPE	LENGTH MM	CATALOGUE NUMBER	WEIGHT KGS
------	--------------	---------------------	---------------

154

MSB Saga 1000

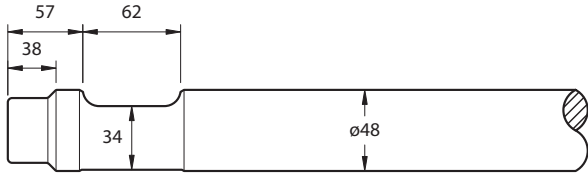

Point	500	MS26P0500	6
Chisel	500	MS26C0500	6

155

MSB Saga 1500

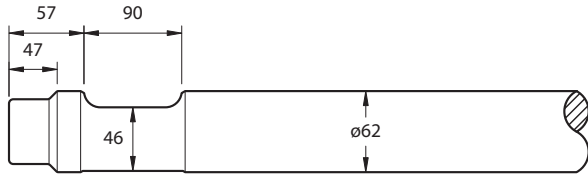

Point	580	MS27P0580	11
Chisel	580	MS27C0580	11

156

MSB Saga 2000

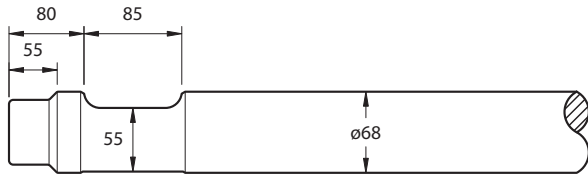

Point	630	MS28P0630	15
Chisel	630	MS28C0630	15

Figure
No.

TYPE	LENGTH MM	CATALOGUE NUMBER	WEIGHT KGS
------	--------------	---------------------	---------------

157

NPK E-102

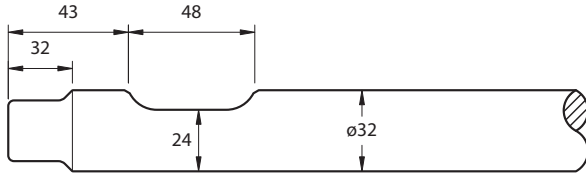

Point	390	NP58P0390	2
Chisel	390	NP58C0390	2

158

NPK E-106

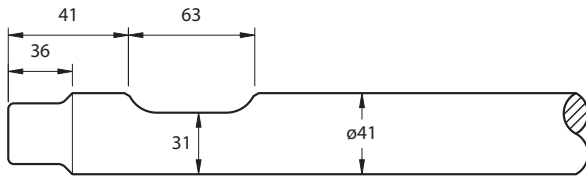

Point	410	NP59P0410	4
Chisel	410	NP59C0410	4

159

NPK E-200

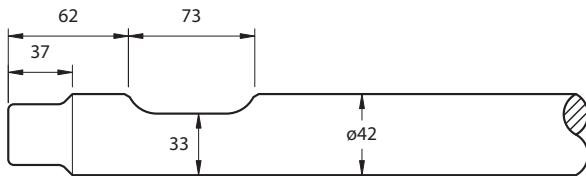

Point	500	NP43P0500	5
Chisel	500	NP43C0500	5

160

NPK E-201

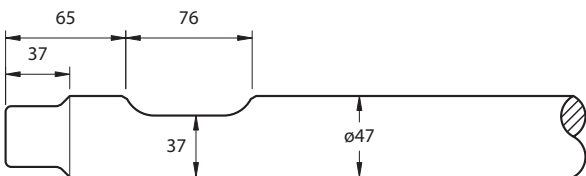

Point	550	NP44P0550	6
Chisel	550	NP44C0550	6

161

NPK E-202

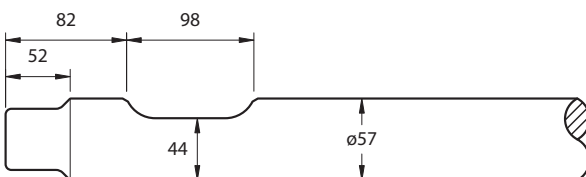

Point	650	NP45P0650	9
Chisel	650	NP45C0650	9

162

NPK E-203

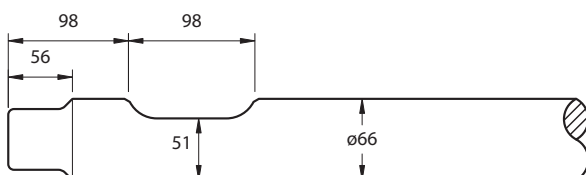

Point	700	NP46P0700	17
Chisel	700	NP46C0700	17

Figure No.

TYPE	LENGTH MM	CATALOGUE NUMBER	WEIGHT KGS
------	-----------	------------------	------------

163

NPK E-204

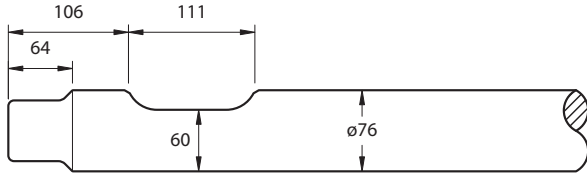

Point	750	NP47P0750	22
Chisel	750	NP47C0750	22

164

NPK E-205

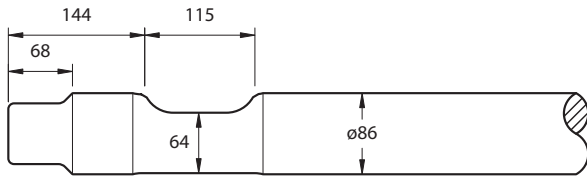

Point	850	NP48P0850	31
Chisel	850	NP48C0850	31

165

NPK E-206

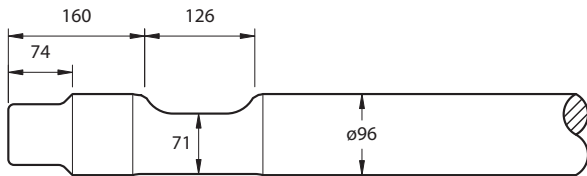

Point	940	NP49P0940	49
Chisel	940	NP49C0940	49

166

NPK E-207

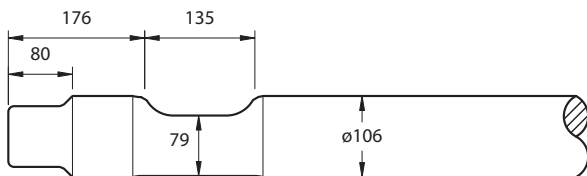

Point	950	NP53P0950	63
Chisel	950	NP53C0950	63

167

NPK E-208A

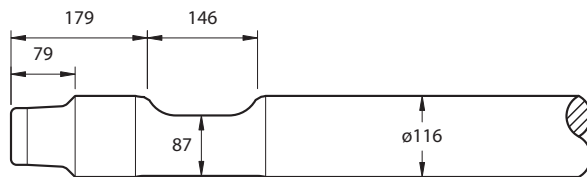

Point	1050	NP54P1050	81
Chisel	1050	NP54C1050	81

168

NPK E-210

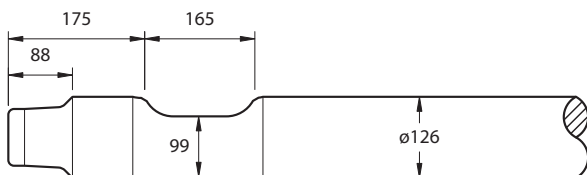

Point	1100	NP26P1100	93
Chisel	1100	NP26C1100	93

Figure No.

TYPE	LENGTH MM	CATALOGUE NUMBER	WEIGHT KGS
------	-----------	------------------	------------

169

NPK E-213

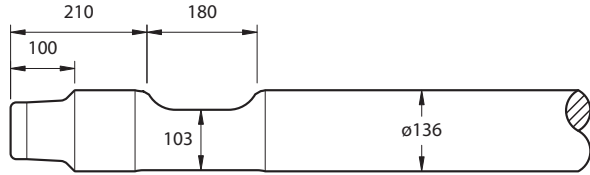

Point	1200	NP34P1200	121
Chisel	1200	NP34C1200	121
Blunt	1100	NP34B1100	111

170

NPK E-216

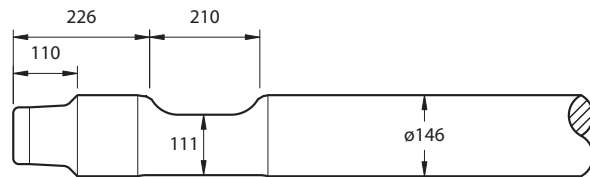

Point	1300	NP37P1300	145
Chisel	1300	NP37C1300	145
Blunt	1150	NP37B1150	129

171

NPK E-220

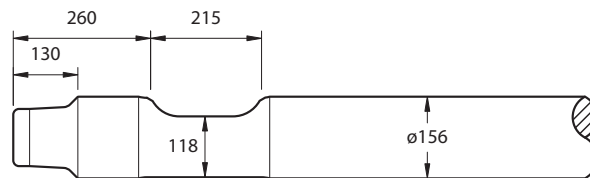

Point	1350	NP35P1350	183
Chisel	1350	NP35C1350	183
Blunt	1200	NP35B1200	163

172

NPK E-225

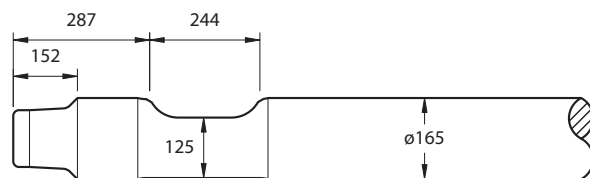

Point	1525	NP39P1530	227
Chisel	1525	NP39C1530	227
Blunt	1350	NP39B1350	201

173

NPK E-240A

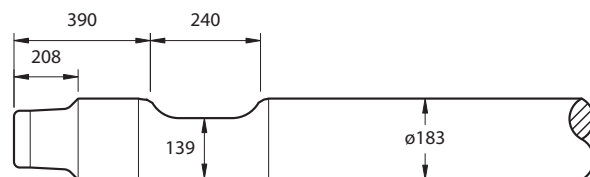

Point	1700	NP56P1800	360
Chisel	1700	NP56C1800	360
Blunt	1500	NP56B1500	318

174

NPK GH10

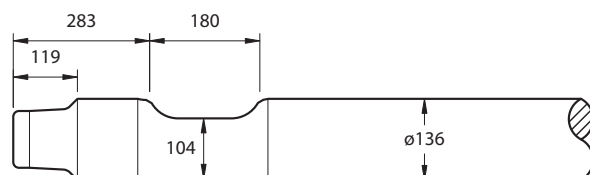

Point	1200	NP55P1200	115
Chisel	1200	NP55C1200	115
Blunt	1100	NP55B1100	105

Figure
No.

TYPE	LENGTH MM	CATALOGUE NUMBER	WEIGHT KGS
------	--------------	---------------------	---------------

175

NPK H-06X

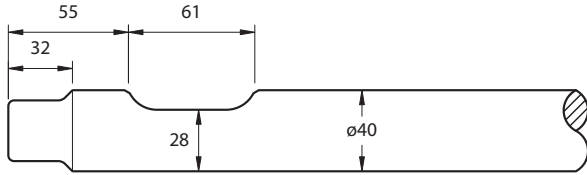

Point 470
Chisel 470

NP10P0470
NP10C0470

4
4

176

NPK H-08XA

Arrowhead 2T

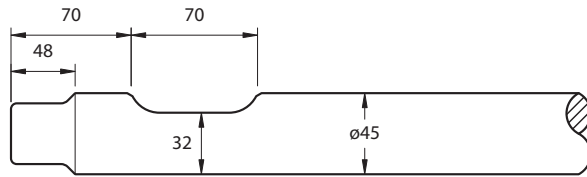

Point 480
Chisel 480

NP11P0480
NP11C0480

5
5

177

NPK H-1XA

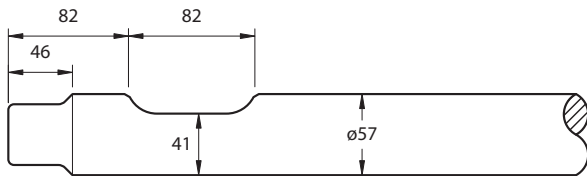

Point 580
Chisel 580

NP13P0580
NP13C0580

10
10

178

NPK H-2XA/H-2XE

Arrowhead 4T

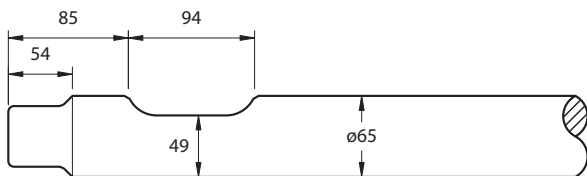

Point 620
Chisel 620

NP14P0620
NP14C0620

15
15

179

NPK H-3XA/H-3XE

Arrowhead 6T

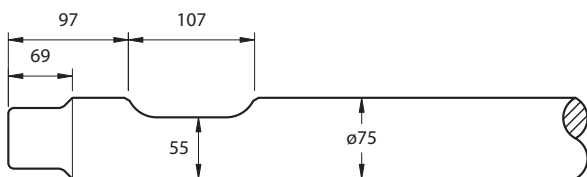

Point 710
Chisel 710

NP16P0710
NP16C0710

21
21

180

NPK H-4X

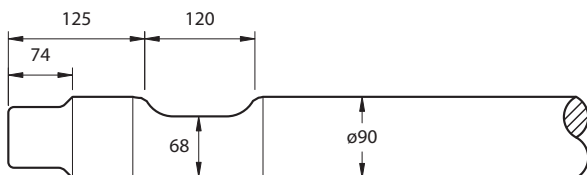

Point 780
Chisel 780

NP17P0780
NP17C0780

32
32

Figure No.

TYPE	LENGTH MM	CATALOGUE NUMBER	WEIGHT KGS
------	--------------	---------------------	---------------

181

NPK H-6XA

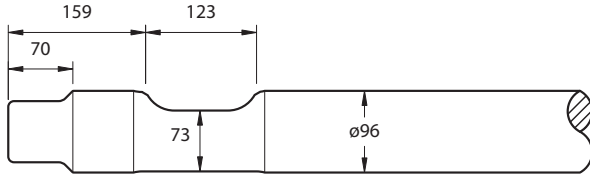

Point	920	NP18P0920	48
Chisel	920	NP18C0920	48

182

NPK H-7XA

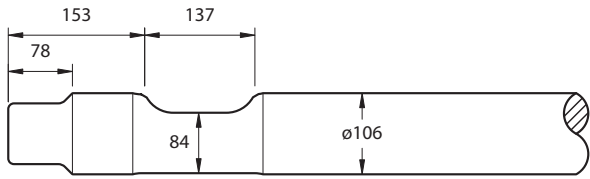

Point	930	NP20P0930	57
Chisel	930	NP20C0930	57

183

NPK H-8XA

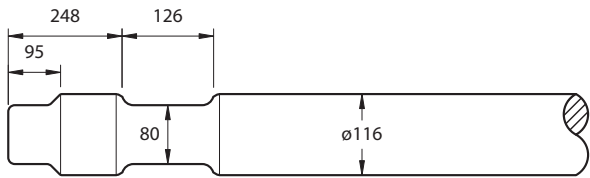

Point	1015	NP22P1015	74
Chisel	1015	NP22C1015	74

184

NPK H-10XB/H-10XE

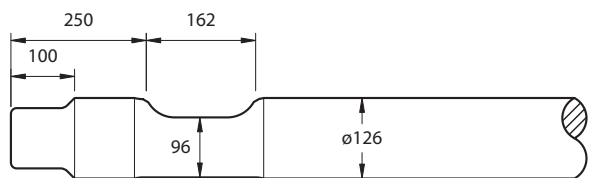

Point	1100	NP27P1100	93
Chisel	1100	NP27P1100	93
Blunt	1000	NP27B1000	85

185

NPK H-12XE

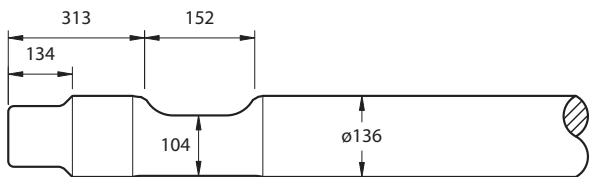

Point	1200	NP28P1200	115
Chisel	1200	NP28C1200	115
Blunt	1100	NP28B1100	106

Figure
No.

TYPE	LENGTH MM	CATALOGUE NUMBER	WEIGHT KGS
------	--------------	---------------------	---------------

186

Rammer S18/ Piccolo

Kubota KXB300/350, Volvo HB80

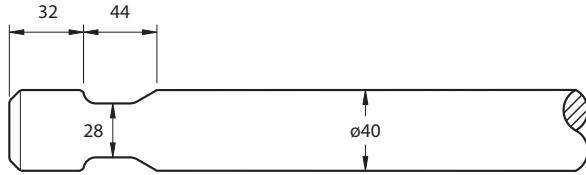

Point	400	RM60P0400	4
Chisel	400	RM60C0400	4

187

Rammer S21

Caterpillar H45FT, Bobcat 1750, Case CB140, JCB HM160, Kubota KXB400/BTB400, O&K H32, Volvo HB130



Point	480	RM11P0480	5
Point	560	RM11P0560	6
Chisel	480	RM11C0480	5
Chisel	560	RM11C0560	6

188

Rammer S22

Caterpillar H50FT, Case CB200, Kubota KXB450, O&K H45, Volvo HB200

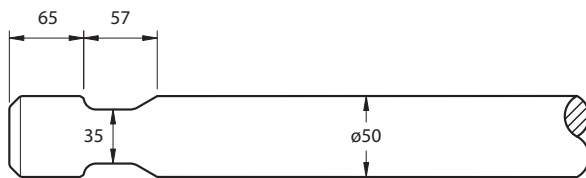

Point	530	RM25P0530	8
Point	600	RM25P0600	9
Chisel	530	RM25C0530	8
Chisel	600	RM25C0600	9

189

Rammer S23

Caterpillar H63/H63FT, Case CB370, JCB HM260, Kubota KXB500, O&K H65, Volvo HB300

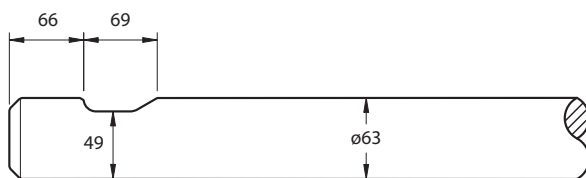

Point	680	RM12P0680	15
Point	780	RM12P0780	17
Chisel	680	RM12C0680	15
Chisel	780	RM12C0780	17

190

Rammer S25

Caterpillar H70/H70FT, Case CB620, JCB HM360, Kubota KXB600, O&K H85, Volvo HB440

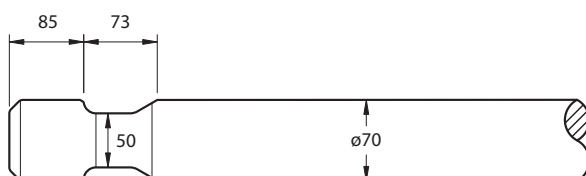

Point	730	RM14P0730	20
Point	830	RM14P0830	23
Chisel	730	RM14C0730	20
Chisel	830	RM14C0830	23

191

Rammer S26

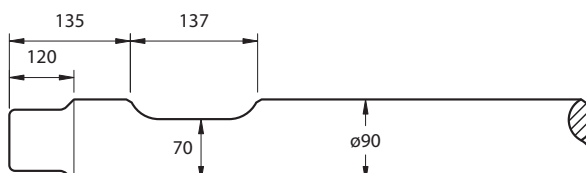

Point	850	RM15P0850	35
Chisel	850	RM15C0850	35

Figure
No.

TYPE	LENGTH MM	CATALOGUE NUMBER	WEIGHT KGS
------	--------------	---------------------	---------------

192

Rammer S27

Caterpillar H90/H90FT, Case CB735, JCB HM550, O&K H120, Volvo HB600

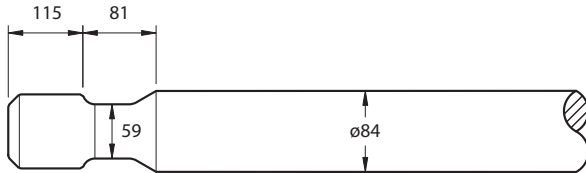

Point	840	RM27P0840	34
Chisel	840	RM27C0840	34

193

Rammer S29

Caterpillar H100/H100FT, Case CB1150, JCB HM850, O&K H150, Volvo HB800

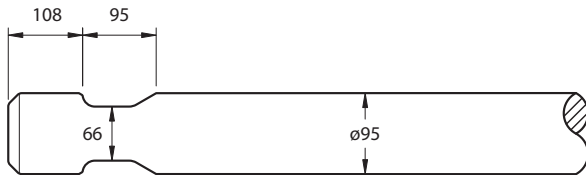

Point	900	RM24P0900	47
Chisel	900	RM24C0900	47

194

Rammer S52

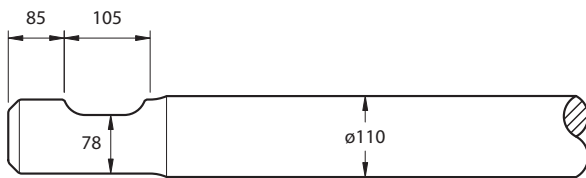

Point	900	RM16P0900	55
Chisel	900	RM16C0900	55

195

Rammer S54

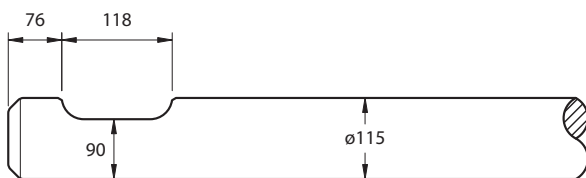

Point	1050	RM17P1050	80
Chisel	1050	RM17C1050	80

196

Rammer S55/E66

Caterpillar H120s, Case CB2850, JCB HM1350, O&K H260

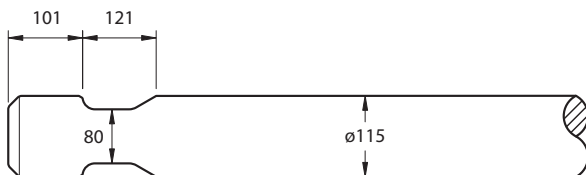

Point	1050	RM18P1050	80
Point	1150	RM18P1150	88
Chisel	1050	RM18C1050	80
Chisel	1150	RM18C1150	88
Blunt	950	RM18B0950	73

197

Rammer S56

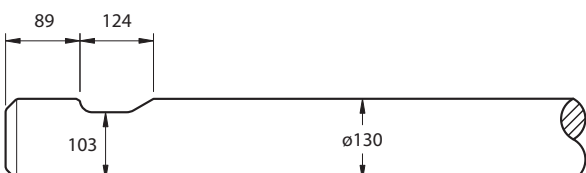

Point	1100	RM19P1100	102
Chisel	1100	RM19C1100	102
Blunt	1000	RM19B1000	93

Figure
No.

TYPE	LENGTH MM	CATALOGUE NUMBER	WEIGHT KGS
------	--------------	---------------------	---------------

198

Rammer S82

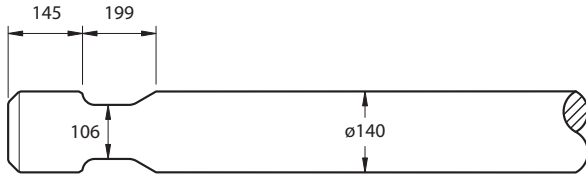

Point	1200	RM20P1200	137
Chisel	1200	RM20C1200	137
Blunt	1050	RM20B1050	122

199

Rammer S83

Caterpillar H140As

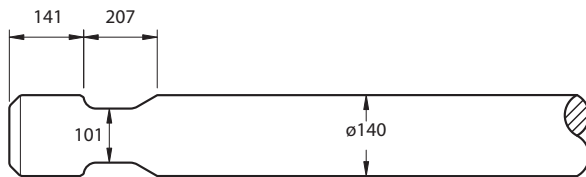

Point	1200	RM21P1200	137
Chisel	1200	RM21C1200	137
Blunt	1050	RM21B1050	122

200

Rammer S84

Caterpillar H160As

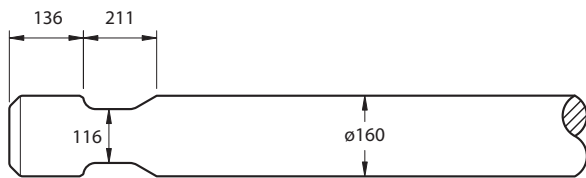

Point	1350	RM22P1350	195
Chisel	1350	RM22C1350	195
Blunt	1200	RM22B1200	173

201

Rammer S86

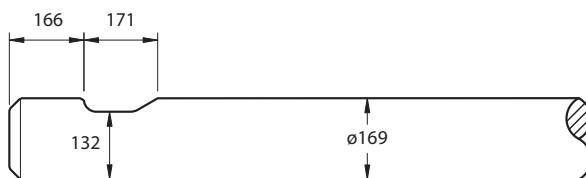

Point	1450	RM23P1450	240
Chisel	1450	RM23C1450	240
Blunt	1300	RM23B1300	215

202

Rammer E63

JCB HM1150, Volvo HB1100

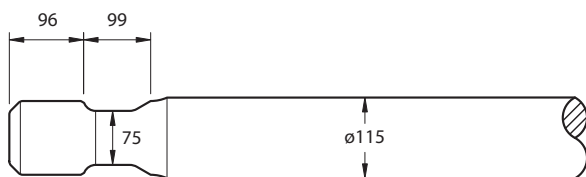

Point	1000	RM34P1000	68
Chisel	1000	RM34C1000	68

203

Rammer E64

Caterpillar H115s, Case CB1450, JCB HM1050, O&K H200

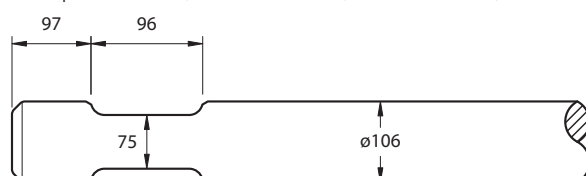

Point	1050	RM30P1050	64
Point	1150	RM30P1150	70
Chisel	1050	RM30C1050	64
Chisel	1150	RM30C1150	70

Figure
No.

TYPE	LENGTH MM	CATALOGUE NUMBER	WEIGHT KGS
------	--------------	---------------------	---------------

204

Rammer E65

JCB HM1450, Volvo HB1400

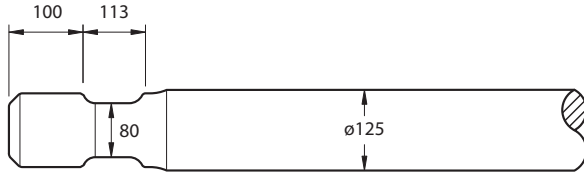

Point	1050	RM33P1050	80
Chisel	1050	RM33C1050	80
Blunt	850	RM33B0850	69

205

Rammer E66/S55

Caterpillar H120s, Case CB2850, JCB HM1350, O&K H260

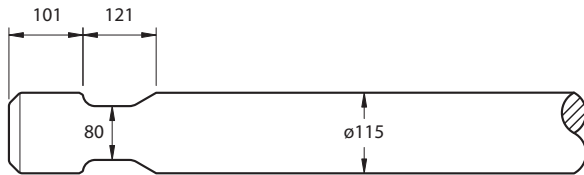

Point	1050	RM18P1050	80
Point	1150	RM18P1150	88
Chisel	1050	RM18C1050	80
Chisel	1150	RM18C1150	88
Blunt	950	RM18B0950	73

206

Rammer E68

Caterpillar H130s, Case CB3750, JCB HM1750, O&K H310, Volvo HB1700

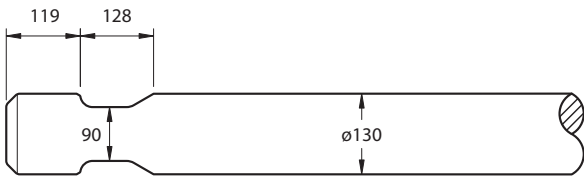

Point	1100	RM32P1100	102
Point	1200	RM32P1200	111
Chisel	1100	RM32C1100	102
Chisel	1200	RM32C1200	111
Blunt	900	RM32B0900	84

207

Rammer G80

Caterpillar H140Cs/140Ds, Case CB4000, JCB HM2350, O&K H380, Volvo HB2400

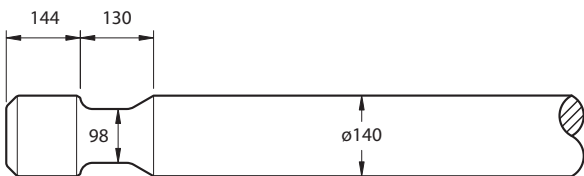

Point	1200	RM35P1200	137
Chisel	1200	RM35C1200	137
Blunt	1050	RM35B1050	122

208

Rammer G90

Caterpillar H160Cs/160Ds, Case CB5200, JCB HM2950, O&K H530, Volvo HB3200

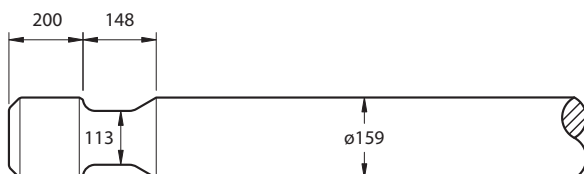

Point	1400	RM36P1400	206
Chisel	1400	RM36C1400	206
Blunt	1250	RM36B1250	184

209

Rammer G100

Caterpillar H180s, JCB HM3850

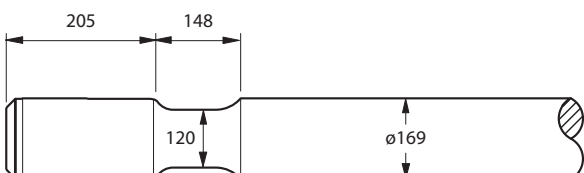

Point	1450	RM41P1450	240
Chisel	1450	RM41C1450	240
Blunt	1300	RM41B1300	215

Figure
No.

TYPE	LENGTH MM	CATALOGUE NUMBER	WEIGHT KGS
------	--------------	---------------------	---------------

210

Rammer G110

Caterpillar H180Ds, JCB HM3950, O&K H700, Volvo HB3800

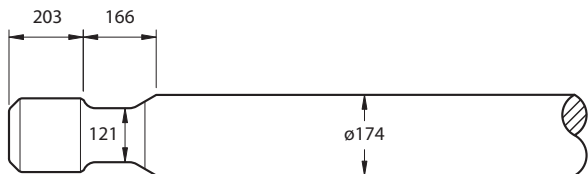

Point	1450	RM42P1450	240
Chisel	1450	RM42C1450	240
Blunt	1300	RM42B1300	216

211

Rammer G120

Caterpillar H195

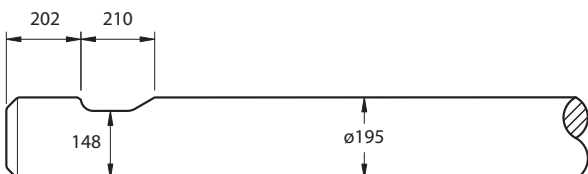

Point	1500	RM40P1500	326
Chisel	1500	RM40C1500	326
Blunt	1350	RM40B1350	294

212

Rammer G130

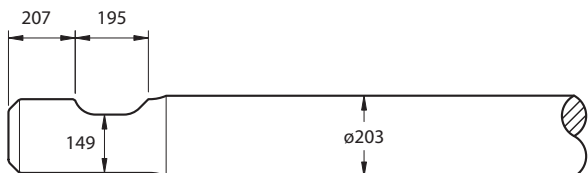

Point	1550	RM43P1550	340
Chisel	1550	RM43C1550	340
Blunt	1400	RM43B1400	308

213

Rammer M14



Point	1100	RM44P1100	92
Chisel	1100	RM44C1100	92

214

Rammer M18

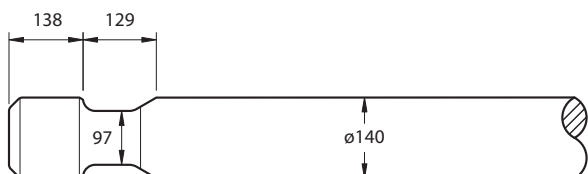

Point	1200	RM45P1200	137
Chisel	1200	RM45C1200	137
Blunt	1100	RM45B1100	126

Figure
No.

TYPE	LENGTH MM	CATALOGUE NUMBER	WEIGHT KGS
------	--------------	---------------------	---------------

215

Rotair OL50

Furukawa F1/HB1G, Gehl G50S

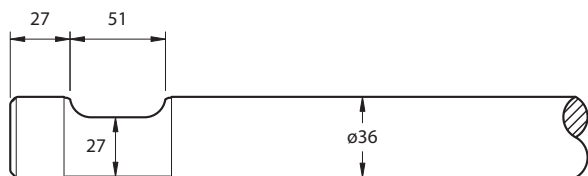

Point	400	FU21P0460	2
Chisel	400	FU21C0460	2

216

Rotair OL90 (With Collar)

Pel-Job MH90, Omal 80S

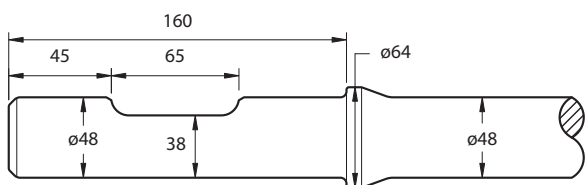

Point	480	PJ11P0480	5
Chisel	480	PJ11C0480	5

217

Rotair OL90/95

Pel-Job MH95, Gehl G95S

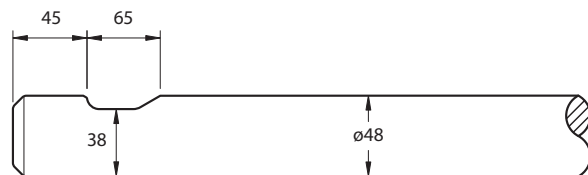

Point	480	RT11P0480	5
Chisel	480	RT11C0480	5

218

Rotair OL130/160

Pel-Job MH130/160, Gehl G160S

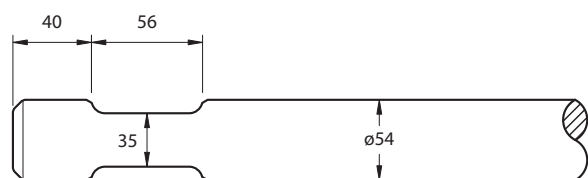

Point	500	RT14P0500	7
Chisel	500	RT14C0500	7

219

Rotair OL180/260

Pel-Job MH180/260, Gehl G260S

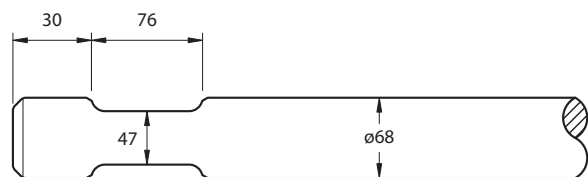

Point	550	RT12P0550	14
Chisel	550	RT12C0550	14

220

Rotair OL250/330

Gehl G330S

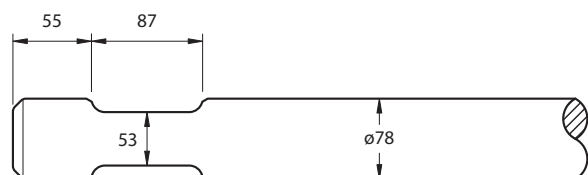

Point	600	RT13P0600	19
Chisel	600	RT13C0600	19

Figure
No.

TYPE	LENGTH MM	CATALOGUE NUMBER	WEIGHT KGS
------	--------------	---------------------	---------------

221

Socomec DMS 50

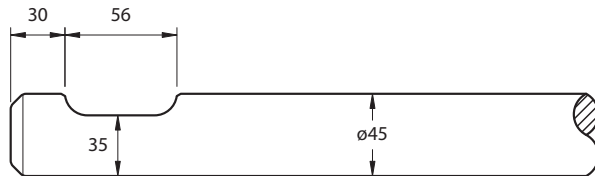

Point	350	S028P0350	3
Chisel	350	S028C0350	3

222

Socomec DMS 95

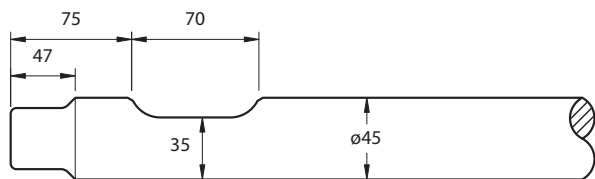

Point	480	S025P0480	5
Chisel	480	S025C0480	5

223

Socomec DMS 160

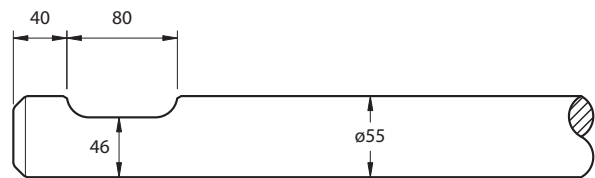

Point	570	S026P0570	14
Chisel	570	S026C0570	14

224

Socomec DMS 220

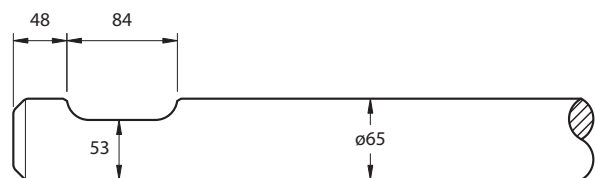

Point	600	S021P0600	17
Chisel	600	S021C0600	17

225

Socomec DMS 330

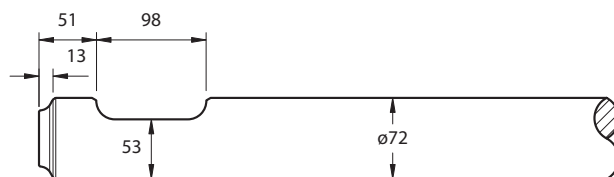

Point	700	S023P0700	21
Chisel	700	S023C0700	21

226

Socomec DMS 430

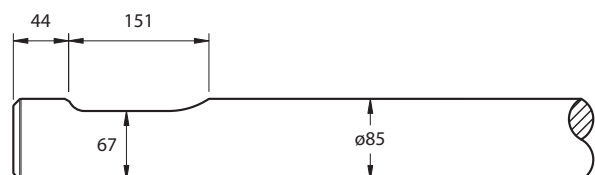

Point	780	S027P0780	30
Chisel	780	S027C0780	30

Figure
No.

TYPE	LENGTH MM	CATALOGUE NUMBER	WEIGHT KGS
------	--------------	---------------------	---------------

227

Socomec DMS 740

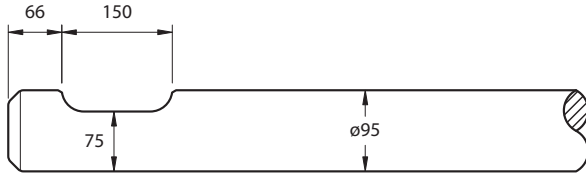

Point	900	S034P0900	46
Chisel	900	S034C0900	46

228

Socomec MDO 550

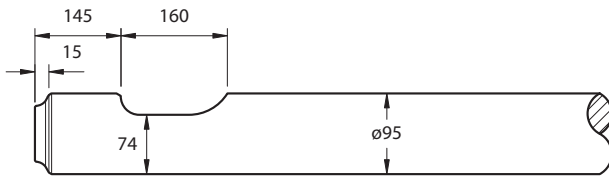

Point	970	S011P0970	50
Chisel	970	S011C0970	50

229

Socomec MDO 750

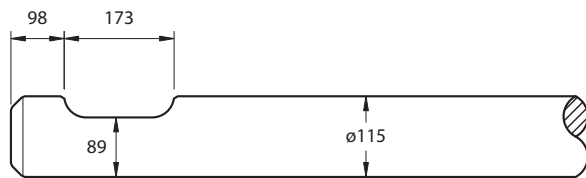

Point	1050	S012P1050	80
Chisel	1050	S012C1050	80

230

Socomec MDO 1450

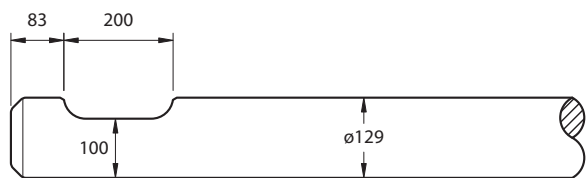

Point	1150	S014P1150	107
Chisel	1150	S014C1150	107
Blunt	1050	S014B1050	98

231

Socomec MDO 1950

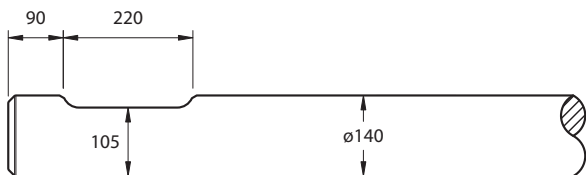

Point	1250	S020P1250	142
Chisel	1250	S020C1250	142
Blunt	1150	S020B1150	131

Figure
No.

TYPE	LENGTH MM	CATALOGUE NUMBER	WEIGHT KGS
------	--------------	---------------------	---------------

232

Soosan SB10

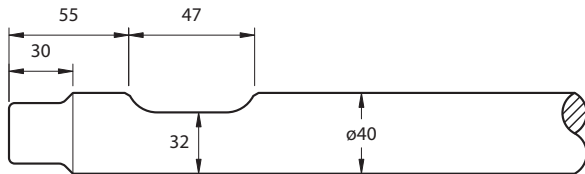

Point	450	SS18P0450	4
Chisel	450	SS18C0450	4

233

Soosan SB20

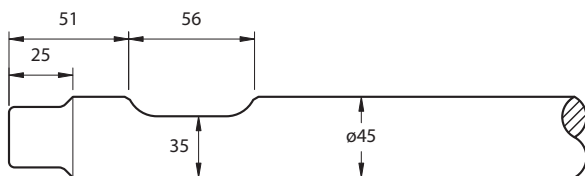

Point	500	SS12P0500	5
Chisel	500	SS12C0500	5

234

Soosan SB30

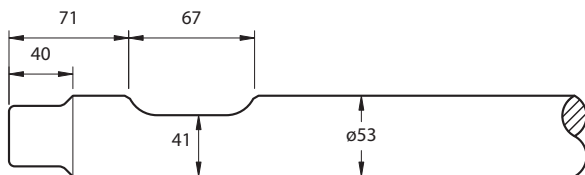

Point	570	SS10P0570	8
Chisel	570	SS10C0570	8

235

Soosan SB40

Stanley MB506

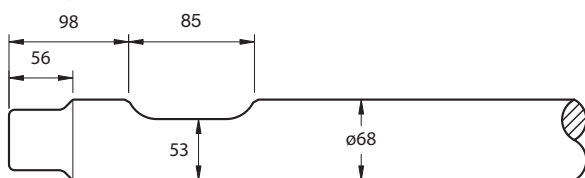

Point	710	SS11P0710	20
Chisel	710	SS11C0710	20

236

Soosan SB43

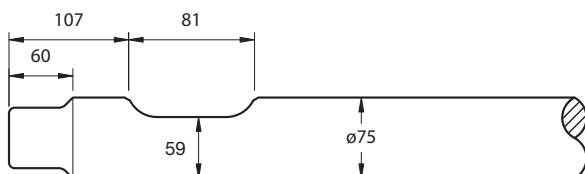

Point	800	SS22P0800	24
Chisel	800	SS22C0800	24

237

Soosan SB45

Stanley MB20EX

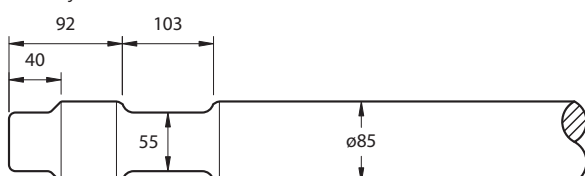

Point	850	SS13P0850	30
Chisel	850	SS13C0850	30

Figure
No.

TYPE	LENGTH MM	CATALOGUE NUMBER	WEIGHT KGS
------	--------------	---------------------	---------------

238

Soosan SB50

Stanley MB30EX

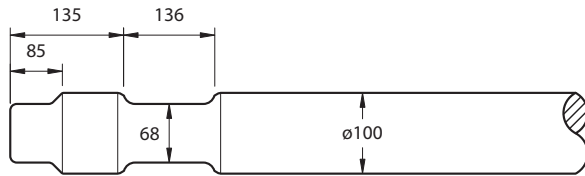

Point	1000	SS14P1000	55
Chisel	1000	SS14C1000	55

239

Soosan SB60

Stanley MB40EX

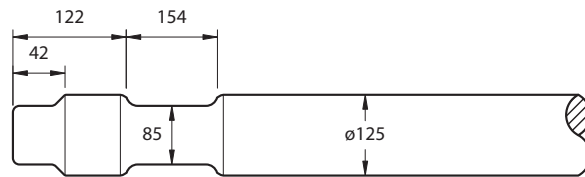

Point	1050	SS16P1050	98
Chisel	1050	SS16C1050	98

240

Soosan SB81

Stanley MB50EX

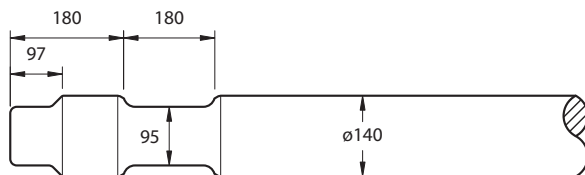

Point	1200	SS20P1200	125
Chisel	1200	SS20C1200	125
Blunt	1100	SS20B1100	115

241

Soosan SB100

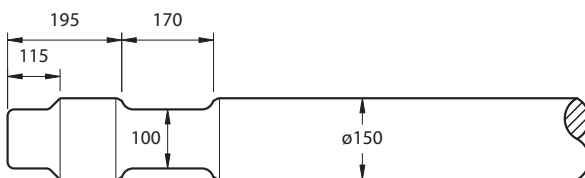

Point	1300	SS23P1300	178
Chisel	1300	SS23C1300	178
Blunt	1200	SS23B1300	165

242

Soosan SB121

Stanley MB70EX

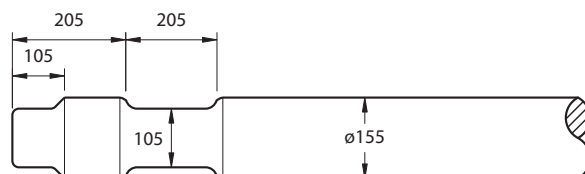

Point	1300	SS19P1300	190
Chisel	1300	SS19C1300	190
Blunt	1200	SS19B1200	176

Figure
No.

243

Soosan SB130/140

Stanley MB80EX

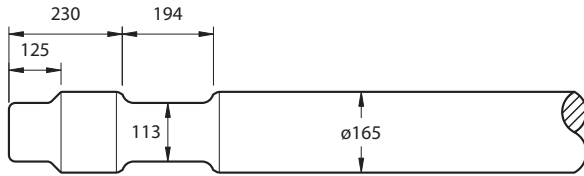

TYPE	LENGTH MM	CATALOGUE NUMBER	WEIGHT KGS
------	--------------	---------------------	---------------

Point	1400	SS24P1400	208
Chisel	1400	SS24C1400	208
Blunt	1250	SS24B1250	186

244

Soosan SB151

Stanley MB100EX

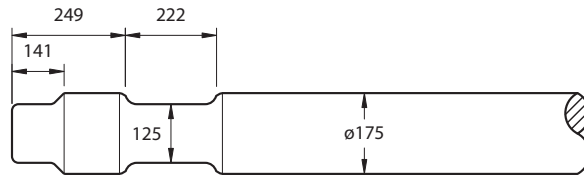

Point	1600	SS21P1600	300
Chisel	1600	SS21C1600	300
Blunt	1450	SS21B1450	272

Figure
No.

TYPE	LENGTH MM	CATALOGUE NUMBER	WEIGHT KGS
------	--------------	---------------------	---------------

245

Toku TNB-08E/1M

Teledyne TB100

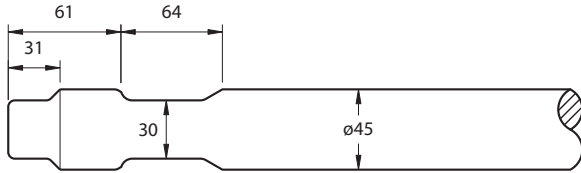

Point	470	TK29P0470	5
Chisel	470	TK29C0470	5

246

Toku TNB-1E/2M

Drago DRH80, Teledyne TB120/125

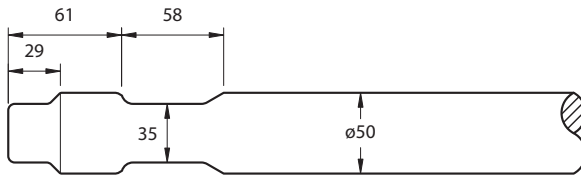

Point	500	TK11P0500	7
Point	600	TK11P0600	8
Chisel	500	TK11C0500	7
Chisel	600	TK11C0600	8

247

Toku TNB-2E/3M

Drago DRH120, Teledyne TB180/225

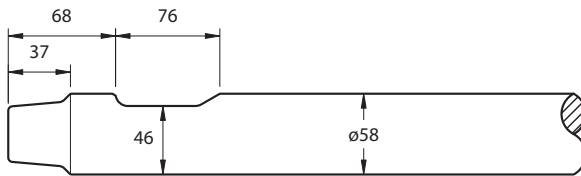

Point	650	TK12P0650	13
Point	700	TK12P0700	14
Chisel	650	TK12C0650	13
Chisel	700	TK12C0700	14

248

Toku TNB-3E/4M

Drago DRH150, Teledyne TB275

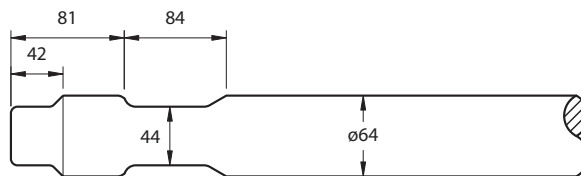

Point	650	TK20P0650	15
Point	700	TK20P0700	16
Chisel	650	TK20C0650	15
Chisel	700	TK20C0700	16

249

Toku TNB-4E/5M

Drago DRH180, Teledyne TB220/325

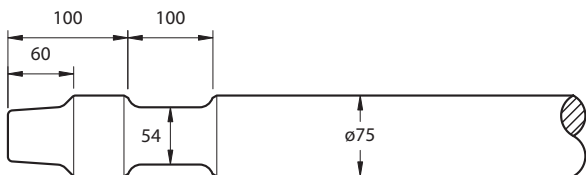

Point	650	TK13P0650	19
Point	720	TK13P0720	21
Chisel	650	TK13C0650	19
Chisel	720	TK13C0720	21

250

Toku TNB-6E/7M

Drago DRH 280, Teledyne TB400/425/625

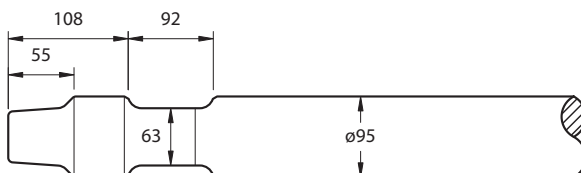

Point	760	TK14P0760	39
Point	850	TK14P0850	44
Chisel	760	TK14C0760	39
Chisel	850	TK14C0850	44

Figure
No.

TYPE	LENGTH MM	CATALOGUE NUMBER	WEIGHT KGS
------	--------------	---------------------	---------------

251

Toku TNB-7E/10E

Drago DRH650S/900, Teledyne TB700/725/750/825

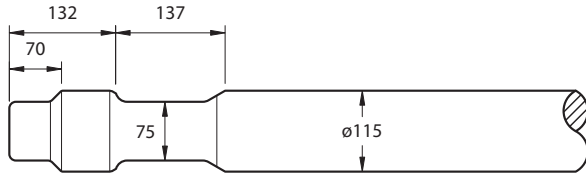

Point	950	TK15P0950	72
Point	1000	TK15P1000	76
Chisel	950	TK15C0950	72
Chisel	1000	TK15C1000	76

252

Toku TNB-14E/16E

Drago DRH1150S/1600S, Teledyne TB900/925/975/1000/1025

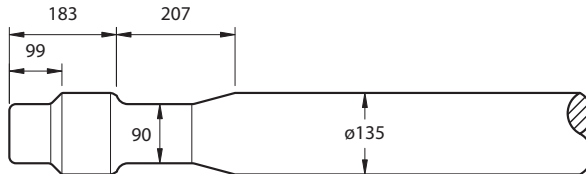

Point	1150	TK16P1150	115
Chisel	1150	TK16C1150	115
Blunt	1050	TK16B1050	105

253

Toku TNB-22E/23E

Drago DRH1900, Teledyne TB1300/1425

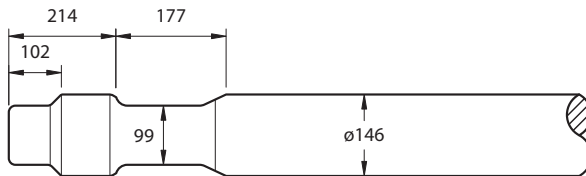

Point	1300	TK18P1300	145
Chisel	1300	TK18C1300	145
Blunt	1150	TK18B1150	129

254

Toku TNB-30E/31E

Teledyne TB1825/2075

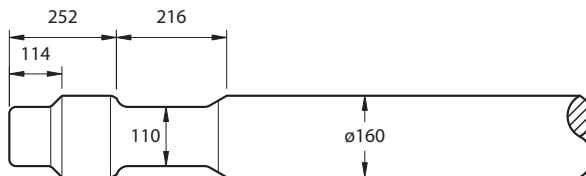

Point	1500	TK27P1500	217
Chisel	1500	TK27C1500	217
Blunt	1350	TK27B1350	196

255

Toku TNB-100

Teledyne TB830

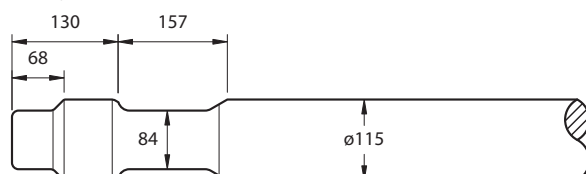

Point	1050	TK21P1050	80
Chisel	1050	TK21C1050	80

Figure
No.

TYPE	LENGTH MM	CATALOGUE NUMBER	WEIGHT KGS
------	--------------	---------------------	---------------

256

Toku TNB-150

Teledyne TB 980

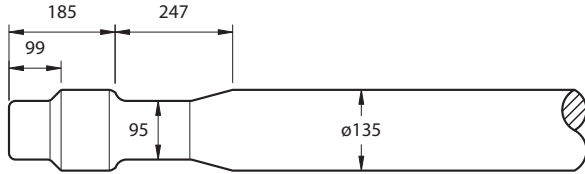

Point	1180	TK22P1180	118
Point	1270	TK22P1270	118
Chisel	1180	TK22C1180	127
Chisel	1270	TK22C1270	127
Blunt	1100	TK22B1100	110

257

Toku TNB-190

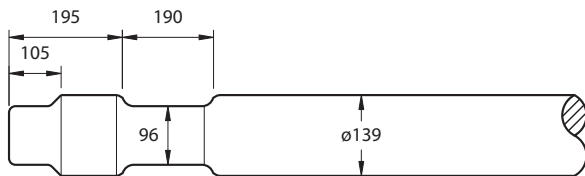

Point	1200	TK25P1200	137
Chisel	1200	TK25C1200	137
Blunt	1100	TK25B1100	126

258

Toku TNB-230

Teledyne TB1680

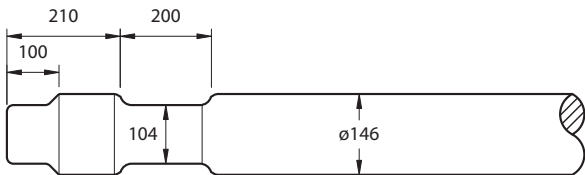

Point	1220	TK23P1220	151
Chisel	1220	TK23C1220	151
Blunt	1100	TK23B1100	136

259

Toku TNB-310

Teledyne TB 2080

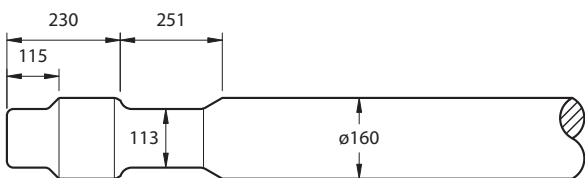

Point	1350	TK27P1350	212
Chisel	1350	TK27C1350	212
Blunt	1200	TK27B1200	189

260

Toku TNB-400

Teledyne TB 2580

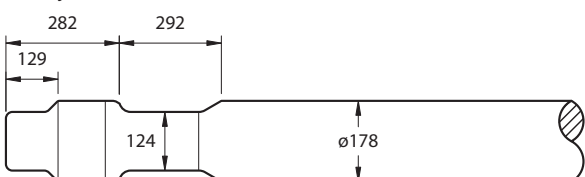

Point	1550	TK32P1550	310
Chisel	1550	TK32C1550	310
Blunt	1400	TK32B1400	378



Figure No.

TYPE	LENGTH MM	CATALOGUE NUMBER	WEIGHT KGS
------	-----------	------------------	------------

261

Toyo THBB31

Dehaco DHB35, JKHB31, Takeuchi TKB31

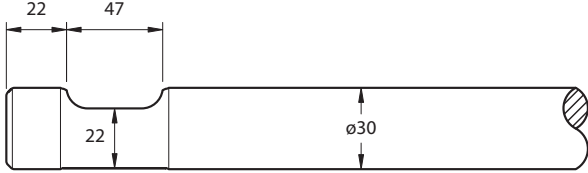

Point	350
Chisel	350

T018P0350
T018C0350

2
2

262

Toyo THBB51

Dehaco DHB55, JKHB51, Takeuchi TKB51

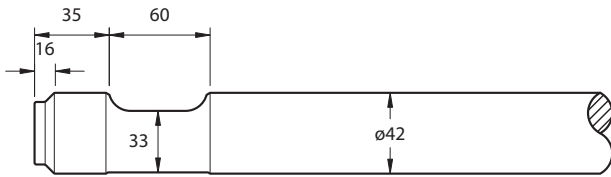

Point	400
Chisel	400

T019P0400
T019C0400

4
4

263

Toyo THBB71

Dehaco DHB75, JKHB71, Takeuchi TKB71



Point	450
Chisel	450

T011P0450
T011C0450

5
5

264

Toyo THBB101

Dehaco DHB165, JKHB101, Takeuchi TKB101

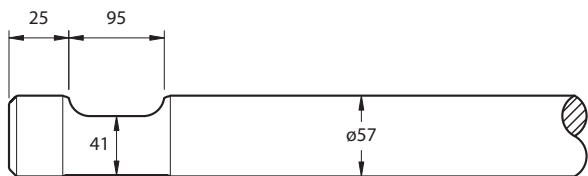

Point	550
Chisel	550

T012P0550
T012C0550

10
10

265

Toyo THBB201

Takeuchi TKB201

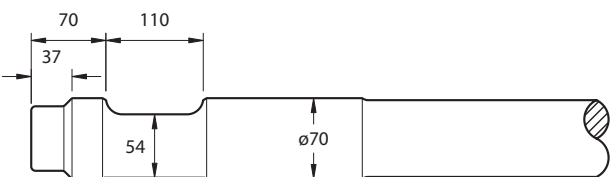

Point	700
Chisel	700

T023P0700
T023C0700

19
19



TYPE	LENGTH MM	CATALOGUE NUMBER	WEIGHT KGS
------	--------------	---------------------	---------------

Figure
No.

266

Toyo THBB301

Dehaco DHB305, JKHB301, Takeuchi TKB301

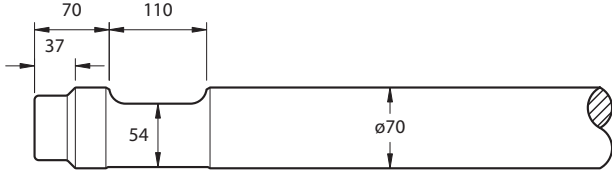

Point	750	T013P0750	21
Chisel	750	T013C0750	21

267

Toyo THBB401

Dehaco DHB405, JKHB401, Takeuchi TKB 401

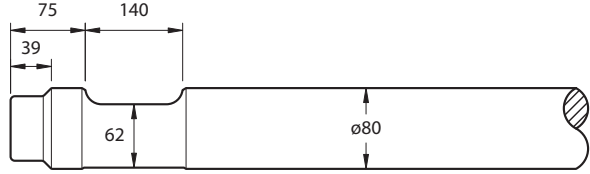

Point	900	T014P0900	30
Chisel	900	T014C0900	30

268

Toyo THBB801

Dehaco DHB805, JKHB801, Takeuchi TKB801

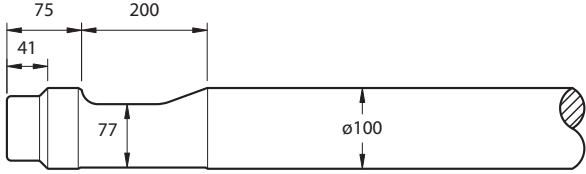

Point	960	T015P0960	53
Chisel	960	T015C0960	53

269

Toyo THBB1101

Dehaco DHB1250, JKHB1101, Takeuchi TKB1101

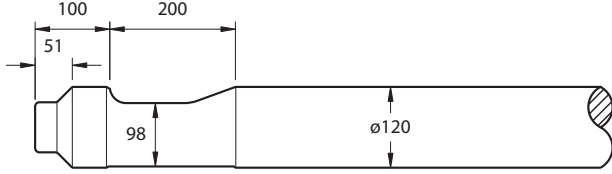

Point	1050	T020P1050	91
Chisel	1050	T020C1050	91

270

Toyo THBB1401

Dehaco DHB1305, JKHB 1401, Takeuchi TKB1401

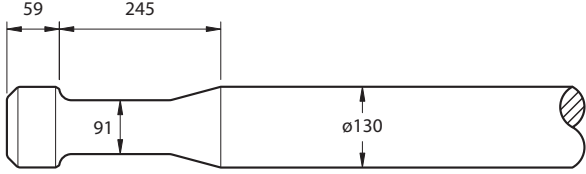

Point	1050	T016P1050	101
Chisel	1050	T016C1050	101



TYPE	LENGTH MM	CATALOGUE NUMBER	WEIGHT KGS
------	--------------	---------------------	---------------

Figure
No.

271

Toyo THBB1600

Dehaco DHB1605 (1405), JKHB1600, Takeuchi TKB1600

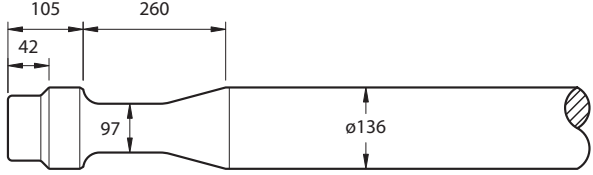

Point	1120	T021P1120	115
Chisel	1120	T021C1120	115
Blunt	1020	T021B1020	105

272

Toyo THBB2000

Dehaco DHB2305, JKHB2000, Takeuchi TKB2000

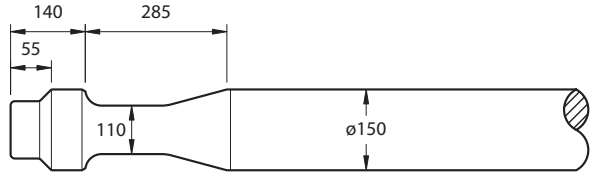

Point	1250	T017P1250	173
Chisel	1250	T017C1250	173
Blunt	1150	T017B1150	160

273

Toyo THBB3000

Dehaco DHB3205 (4105), JKHB3000, Takeuchi TKB3000

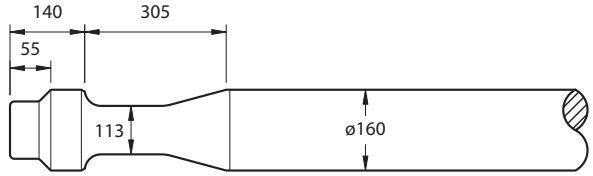

Point	1400	T022P1400	220
Chisel	1400	T022C1400	220
Blunt	1250	T022B1250	197

Other Manufacturers Reference Index

Fig No.	Hammer Type	Diameter mm	Length mm	Cat. No.	Weight kgs
ARDEN					
275	AB 100	45	500	DA10P0500	5
276	AB 150/210	57	600	DA11P0600	11
277	AB 280/350	70	680	DA12P0680	20
279	AB 450	80	840	DA13P0840	27
280	AB 1050	105	1050	DA16P1050	68
ARROWHEAD					
281	S20	45	480	AH10P0480	5
282	S30	53	500	AH11P0500	7
283	S40	65	620	AH12P0620	14
284	S60	75	710	AH14P0710	24
285	10T	95	750	AH16P0950	48
286	22T	126	1100	AH23P1100	93
BOBCAT					
329	1250	45	430	ST12P0430	4
330	1560	45	450	ST14P0430	5
331	2500/2570/3560	64	560	ST13P0560	12
332	5500	70	710	ST15P0710	20
333	6560	77	700	ST16P0700	22
DAEMO					
287	DMB S500	70	680	DM10P0680	20
288	DMB S1300	105	930	DM13P0930	60
289	DMB S1800	120	1000	DM16P1000	84
290	DMB S2200	135	1200	DM14P1200	120
292	DMB S3600	150	1350	DM11P1350	185
D&A					
275	8V	45	500	DA10P0500	5
276	15V/20V	57	600	DA11P0600	11
277	30V/50V	70	680	DA12P0680	20
278	70V	80	840	DA13P0840	27
280	130V	105	1050	DA16P1050	68
293	180V	125	1150	DA18P1150	97
HUSKIE/IZUMI					
294	HH100	40	400		3
295	HH150	50	500	JB10P0500	6
296	HH300	60	600	HU1P0600	11
298	HH750	75	750	JB11P0750	25
299	HH1000	90	850	JB19P0850	34
300	HH2000	115	1000	JB15P1000	76
301	HH3600	135	1150	JB12P1150	115
LIFTON					
303	LH70/80	46	420	LF11P0420	4
304	LH110	55	460	LF12P0460	7
305	LH170	70	550	LF13P0550	16
306	LH360	82	700	LF14P0700	24
307	LH500	100	780	LF15P0780	43

Other Manufacturers Reference Index

Fig No.	Hammer Type	Diameter mm	Length mm	Cat. No.	Weight kgs
OKADA					
309	OKB/UB 301	50	500	OK20P0500	6
310	OKB/UB 301SL	54	550	OK21P0550	8
311	OKB/UB 302	61	550	OK22P0550	11
312	OKB/UB 302A	61	600	OK42P0600	12
313	OKB/UB 303A	66	700	OK23P0700	16
314	OKB/UB 304	74	850	OK24P0850	25
315	OKB/UB 304B	74	750	OK43P0750	25
316	OKB/UB 305	85	900	OK25P0900	32
317	OKB/UB 308	110	1000	OK28P1000	61
318	OKB/UB 310	122	1100	OK30P1100	100
319	OKB/UB 312B	130	1150	OK32P1150	108
320	OKB/UB 316	140	1300	OK36P1300	130
321	OKB/UB 318	150	1400	OK38P1400	193
325	UB 8	98	1000	OK13P1000	54
326	UB11	122	1100	OK41P1100	100
327	UB14	135	1200	OK14P1200	115
328	UB17/OKB17A2	137	1300	OK40P1300	127
STANLEY					
329	MB 125	45	430	ST12P0430	4
330	MB156	45	450	ST14P0450	5
331	MB 250/256/350/356	64	560	ST13P0560	12
332	MB 550	70	710	ST15P0710	20
333	MB 656/675/695	77	700	ST16P0710	22
334	MB 800/856	80	770	ST17P0770	26
335	MB 1550	102	915	ST19P0920	52
336	MB 1950/1975	114	1050	ST21P1050	80
TABE					
341	AGB 100/175/200	50	450	TB16P0450	6
342	AGB 270/275/350/375	65	620	TB10P0620	15
343	AGB 400/475	85	700	TB11P0700	28
344	AGB 700/701/750	105	850	TB12P0850	57
345	AGB 1000/1300/1301	114	1000	TB13P1000	76
347	AGB 1800	135	1100	TB15P1100	119
TOPA					
348	TOPA 70	45	500	TP10P0500	5
349	TOPA 100	56	630	TP11P0630	12
350	TOPA 200	65	740	TP12P0740	17
351	TOPA 300	70	810	TP13P0810	23
352	TOPA 500	85	980	TP14P0980	39
353	TOPA 1000	99	1100	TP15P1100	61
355	TOPA 1500	134	1350	TP16P1350	115
VIBRARAM					
295	VRH-50	50	500	JB10P0500	6
296	VRH-60	60	600	HU1P0600	11
298	VRH-75	75	750	JB11P0750	25
299	VRH-90	90	850	JB19P0850	34
300	VRH-115	115	1000	JB15P1000	76
301	VRH-135	135	1150	JB12P1150	115

Warranty Guide

The purpose of this guide is to provide advice on the correct application of our Demolition Tools and assist in analysing and resolving any complaints immediately they occur.

Cause and Effect of Fatigue Failures

The continuous cycle of compressive and tensile stresses in a Demolition Tool, even under correct operating conditions, creates fatigue stress in the tool which can lead to fatigue failure of the tool before it is worn out. Anything which interferes with the normal operational cycle of compressive and tensile stresses will increase the level of fatigue stress being applied to the tool, increasing the risk of early fatigue failure.

1) Leverage/Bending

The main cause of increased fatigue stress in a demolition tool is any form of side pressure during service which creates bending. Utilising the tool as a lever, using the incorrect driving angle or attempting to break ground using the “pull” of the machine are all detrimental to the life of a demolition tool and should be avoided (see Figure 1).

Figure 1

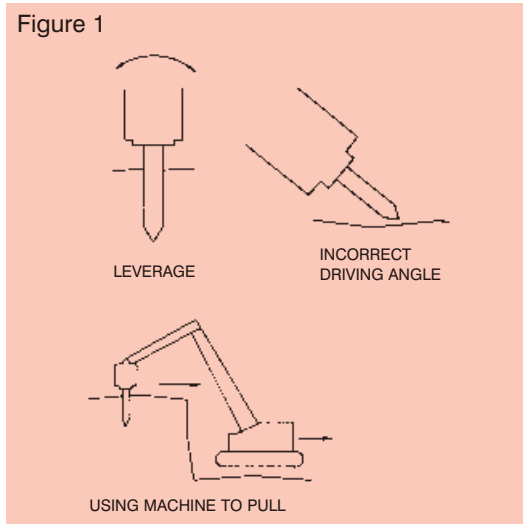

2) “Free Running”/“Blank Firing”

This can arise in any situation where the working end is not in proper contact with the material to be broken. This includes jobs where the tool slides off the work and also when break-through of thin concrete slabs or boulders occurs. It is essential that the tool is applied at a right-angle to the working surface at all times.

3) Lubrication

Regular lubrication is essential. Any form of damage to the surface of a demolition tool renders it more liable to suffer fatigue failure. Care must be taken to prevent accidental gouging or contact welding (“galling” or “pick-up”) due to contact between the tool and chuck bushings either through lack of lubrication or excessive leverage (see Figure 2).

Figure 2

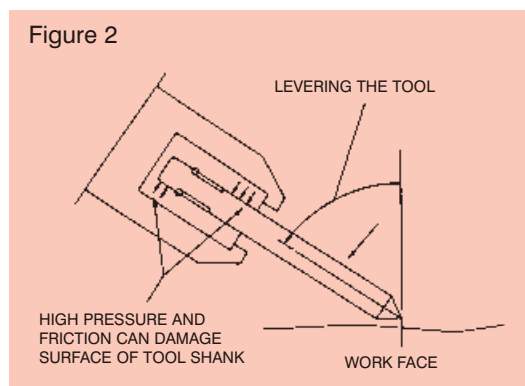

4) Cold/Corrosion

Low temperature causes a Demolition Tool to be more susceptible to fatigue failure. Tools should be kept sheltered from the weather when not in use. A rusty Demolition Tool is more likely to suffer fatigue failure, so tools should be kept well greased.

5) Worn Internal Hammer Parts

Worn hammer parts can cause the tool to be held too “loosely”. This can create surface damage on the tool, which can lead to fatigue failure of the tool. Worn parts can also cause uneven striking on the tool, which may lead to fatigue failure of the tool and damage to the piston.

continued on next page

6) Typical Failures (Guide to Warranty Claims)

Our Demolition Tools are manufactured from first class materials and then heat-treated to produce tools with optimum fatigue and wear resistance. When a tool has apparently failed to give satisfactory service life, a brief visual inspection can often give a quick indication of the cause.

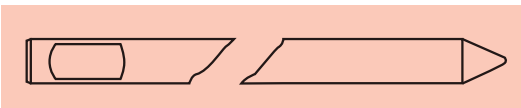
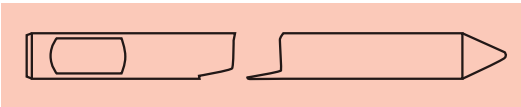
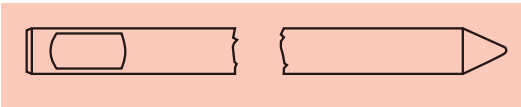

a) Typical fractures caused by excessive bending/leverage of the demolition tool. Warranty claims rejected.

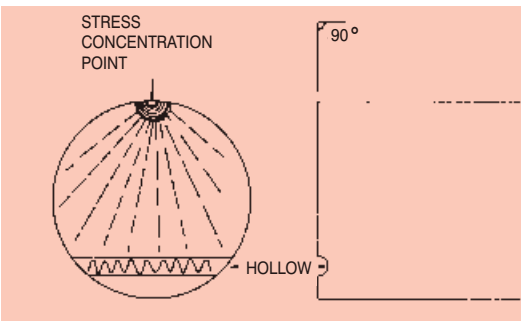

b) Typical of high stress fracture, usually caused by using the tool as an anchor to "pull" the machine. Warranty claims rejected

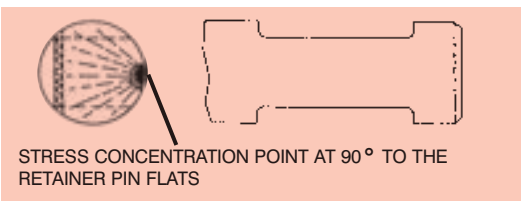

c) Typical fracture caused by levering tool whilst buried in the burden. Warranty claims rejected.

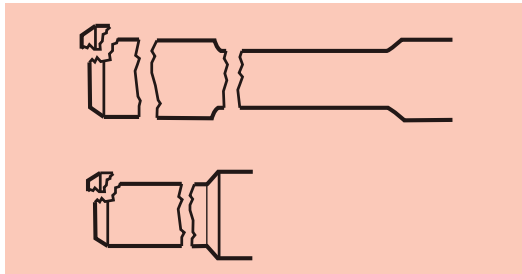

d) Typical fractures caused by blank firing and/or excessive chuck bush wear/damage. Warranty claims rejected.

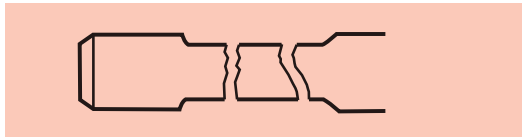

e) Typical fractures caused by blank firing and/or twisting of the tool due to worn/damaged retainer pin. Warranty claims rejected.

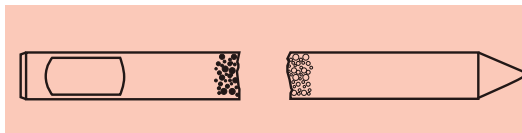

f) Typical fracture caused by lack of lubrication and/or chuck bush wear/damage. Warranty claims rejected.

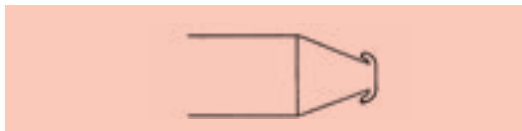

g) Mushrooming: this is caused by driving the chisel or point into hard dense material for too long a period of time without penetration. This generates intense heat, softening the point and causing it to "mushroom". This is not a manufacturing fault. Warranty claims rejected.



h) Note fatigue lines originate from the internal point, not outer diameter. Very rare failure type due to steel defect. 100% warranty accepted.



THOMAS TURTON

© 2013 THOMAS TURTON
Callywhite Lane, Dronfield,
Sheffield S18 2XT, England.





THOMAS TURTON

Callywhite Lane, Dronfield,
Sheffield S18 2XT, England.

Tel: +44 (0) 1246 290000

Fax: +44 (0) 1246 291144

e-mail: info@thomas-turton.co.uk

www.thomas-turton.co.uk

**THOMAS
TURTON**

